



4710 SERIES

VERTICAL MULTISTAGE PUMPS

VM10

ENGINEERING INFORMATION

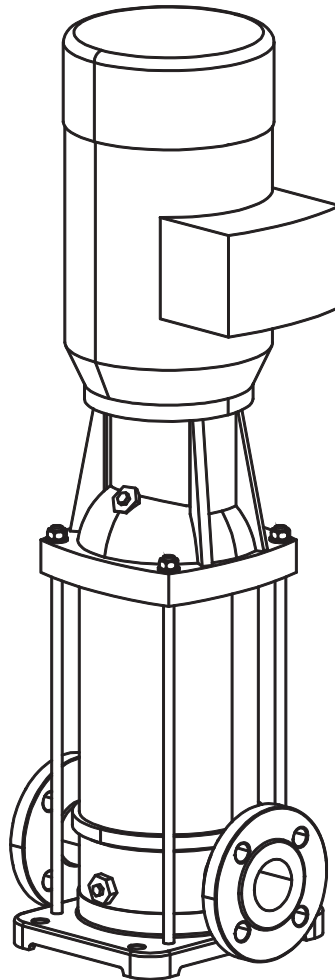

VM10 (1.5x1.5) 2900 RPM

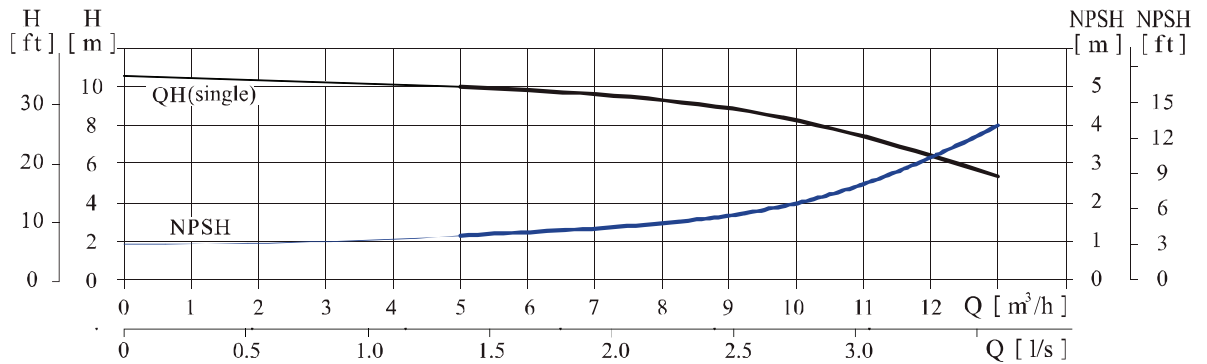
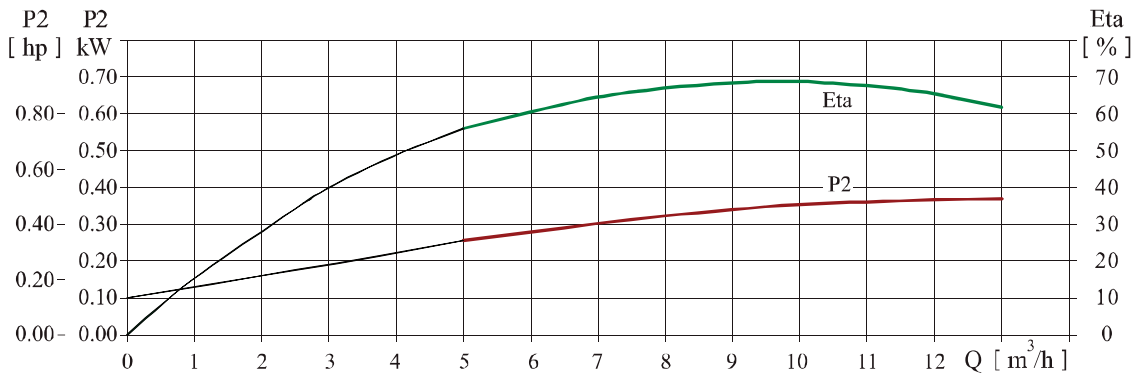
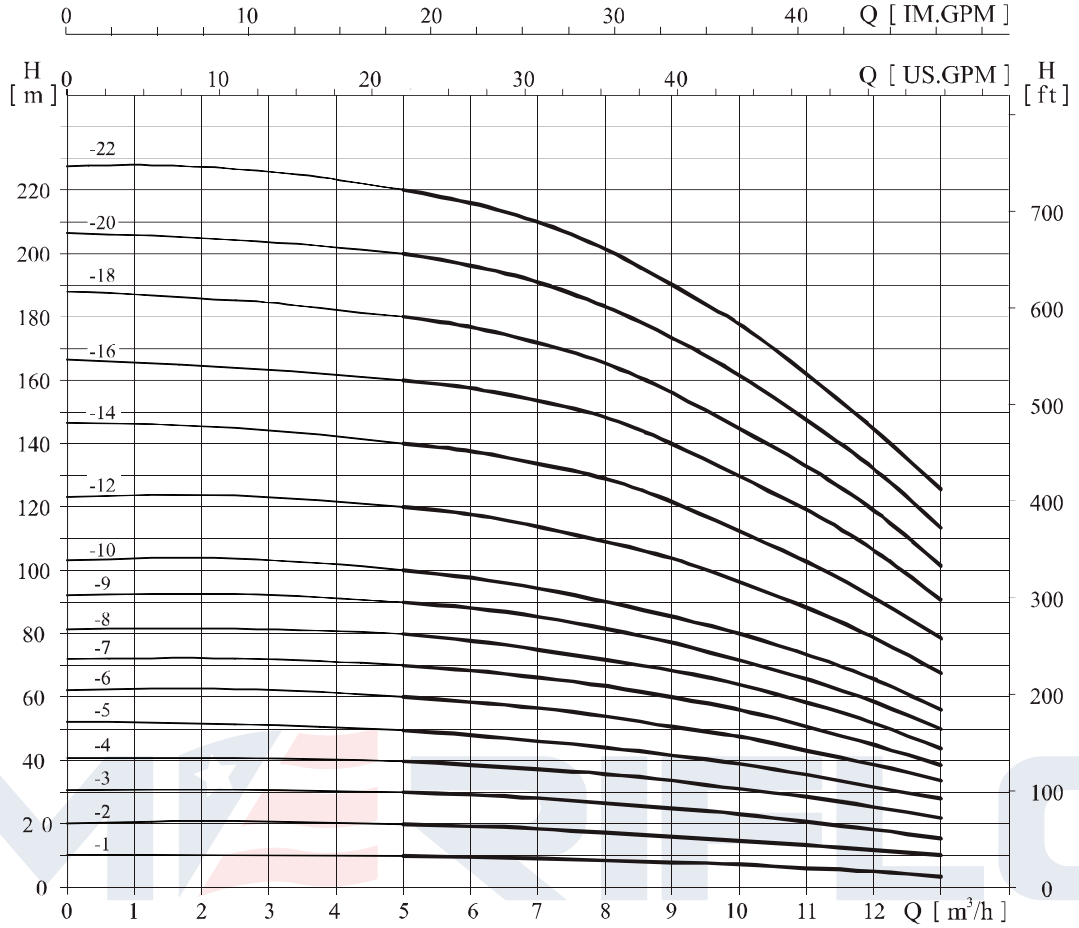
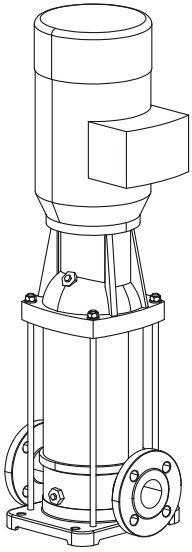

MODEL VM10 - PERFORMANCE TABLE (2900 RPM)

MODEL	SPEED	MOTOR	FLOW	25	30	35	40	45	50	55	
		HP	GPM								
VM10-1	2900	1	HEAD (PSI)	13	13	12	11	10	8.5	6	
VM10-2		1		27	26	24	23	21	19	14	
VM10-3		1.5		41	40	38	36	33	30	23	
VM10-4		2		55	53	51	48	44	40	31	
VM10-5		2		69	67	62	60	55	50	40	
VM10-6		2		82	80	77	72	68	61	48	
VM10-7		5		97	94	89	85	80	72	55	
VM10-8		5		111	107	104	98	91	82	62	
VM10-9		5		124	121	115	109	102	94	71	
VM10-10		5		138	135	128	121	114	105	80	
VM10-12		5		166	160	155	148	136	126	97	
VM10-14		7.5		195	190	183	173	160	146	112	
VM10-16		7.5		224	217	210	199	183	169	129	
VM10-18		10		251	244	236	222	206	189	145	
VM10-20	10	278	271	261	246	230	209	162			
VM10-22	10	307	298	287	270	253	230	179			



VM10 (1.5x1.5) 3500 RPM

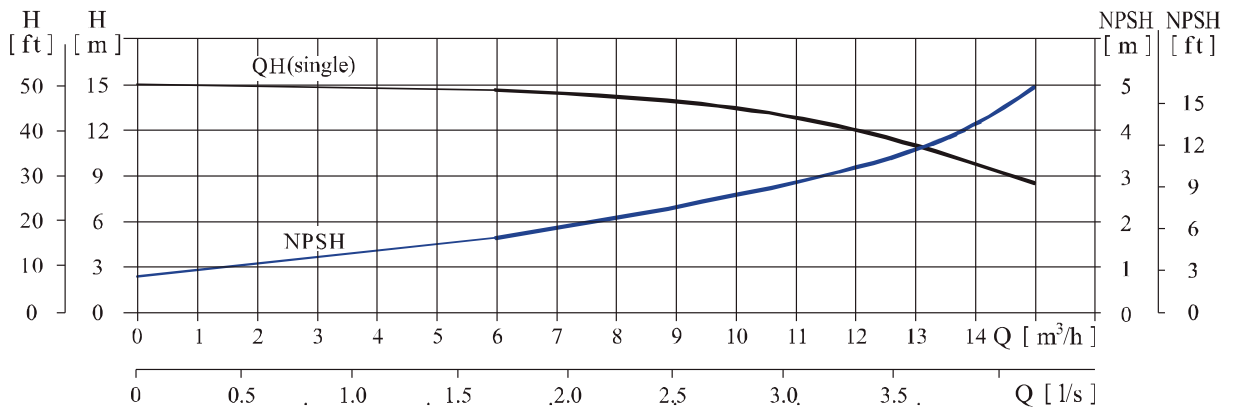
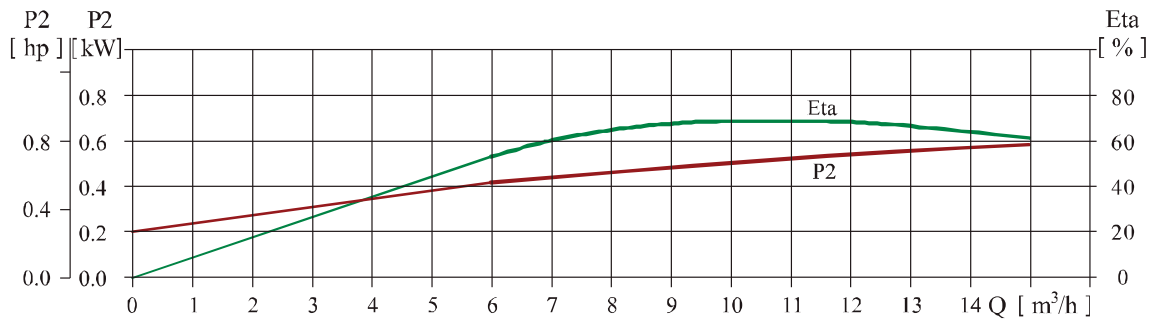
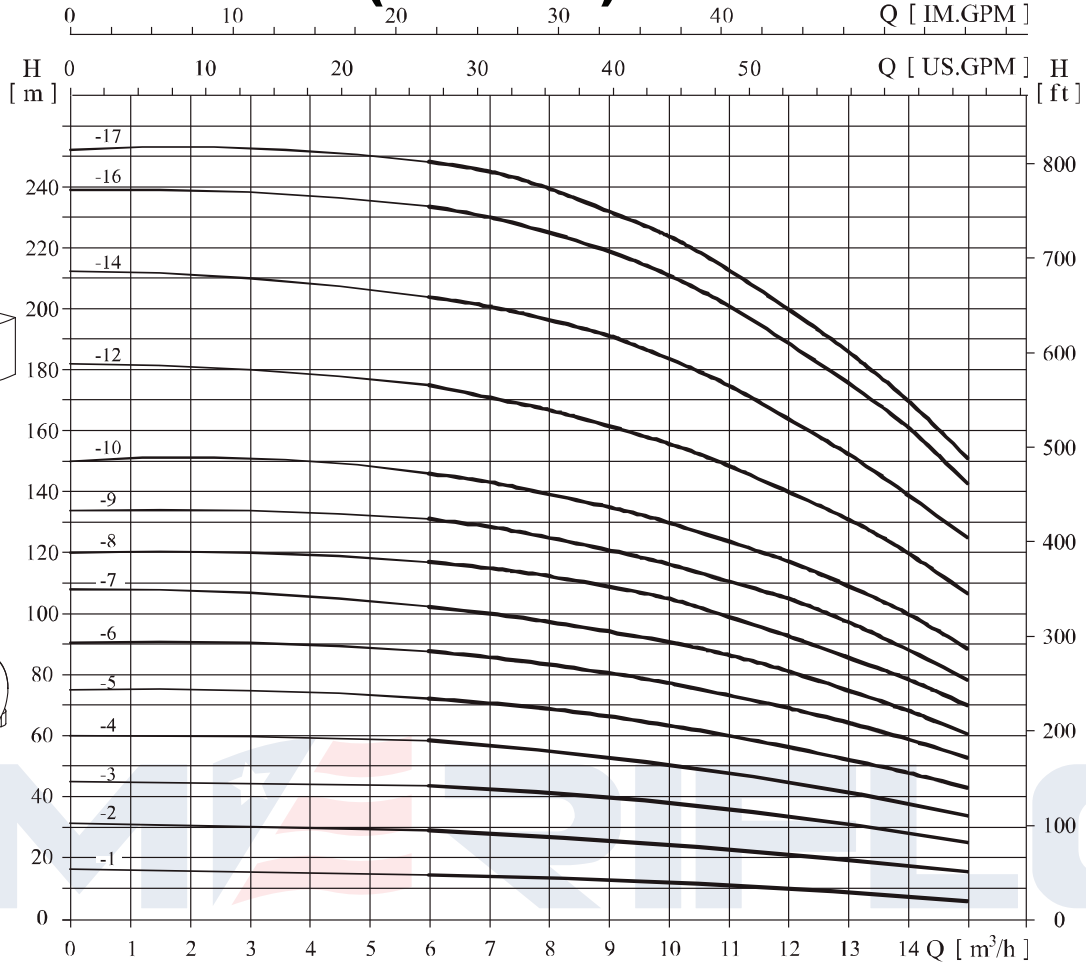
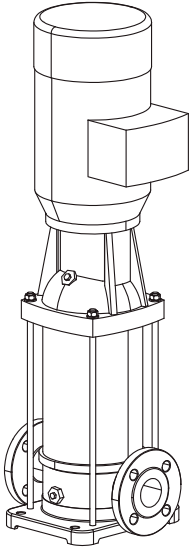

MODEL VM10 - PERFORMANCE TABLE (3500 RPM)

MODEL	SPEED	MOTOR	FLOW	25	30	35	40	45	50	55	60
		HP	GPM								
VM10-1	3500	1	HEAD (PSI)	20	19	18	18	17	16	13	11
VM10-2		2		41	40	38	37	36	33	29	26
VM10-3		3		61	60	58	55	54	51	46	42
VM10-4		5		82	81	78	75	72	68	60	56
VM10-5		5		102	101	98	94	91	87	78	71
VM10-6		5		124	122	118	114	109	105	94	87
VM10-7		7.5		145	142	138	134	128	124	111	102
VM10-8		7.5		166	162	156	153	146	141	127	117
VM10-9		7.5		186	182	178	172	165	158	144	134
VM10-10		10		207	203	197	192	183	175	160	149
VM10-12		10		249	244	237	232	222	212	192	178
VM10-14		15		290	285	278	271	260	249	225	208
VM10-16		15		331	327	318	311	298	284	258	239
VM10-17		15		352	348	340	331	314	303	274	253

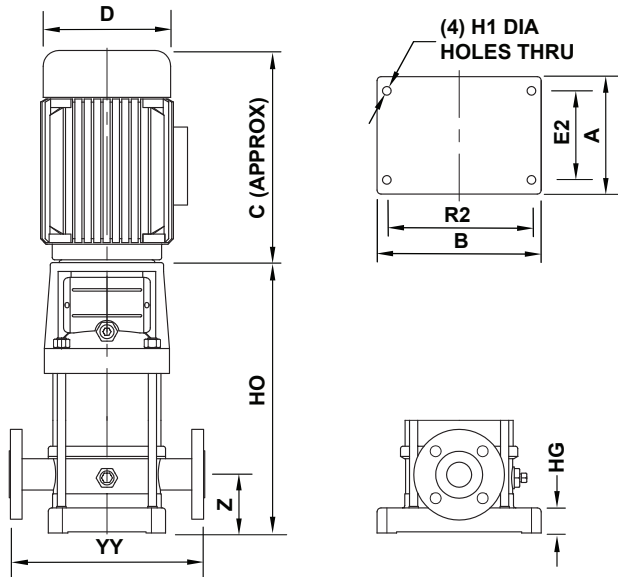

AMERIFLO**MODEL VM10 - VERTICAL MULTISTAGE, ELECTRIC NEMA MOTOR****GENERAL ARRANGEMENT DRAWING**

FLANGE DRILLING STANDARD & DETAILS						
SUCT	250# ANSI		DISC	250# ANSI		
	SIZE	RF DIA	P.C.D	# HOLES	SIZE	
SUCT	1.50	2.875	4.500	4	0.750	
DISC	1.50	2.875	4.500	4	0.750	
FORCES (LBS) & MOMENTS (LB-Feet)						
	Fx	Fy	Fz	Mx	My	Mz
SUCT	160	130	200	340	170	260
DISC	160	130	200	340	170	260

VM10

MODEL	SPEED RPM	A	B	C	D	E2	H1	HG	HO	R2	YY	Z	WEIGHT	
													LBS	
VM10-1	2900	7.875	9.750	9.750	6.750	5.188	0.500	1.000	13.750	8.500	11.000	3.188	88	
VM10-2		7.875	9.750	9.750	6.750	5.188	0.500	1.000	13.750	8.500	11.000	3.188	90	
VM10-3		7.875	9.750	9.750	6.750	5.188	0.500	1.000	14.875	8.500	11.000	3.188	95	
VM10-4		7.875	9.750	11.413	7.500	5.188	0.500	1.000	16.438	8.500	11.000	3.188	108	
VM10-5		7.875	9.750	11.413	7.500	5.188	0.500	1.000	17.625	8.500	11.000	3.188	117	
VM10-6		7.875	9.750	11.413	7.500	5.188	0.500	1.000	18.750	8.500	11.000	3.188	119	
VM10-7		7.875	9.750	13.625	7.750	5.188	0.500	1.000	20.375	8.500	11.000	3.188	141	
VM10-8		7.875	9.750	13.625	7.750	5.188	0.500	1.000	21.500	8.500	11.000	3.188	143	
VM10-9		3500	7.875	9.750	13.625	7.750	5.188	0.500	1.000	22.750	8.500	11.000	3.188	146
VM10-10			7.875	9.750	14.000	9.000	5.188	0.500	1.000	23.875	8.500	11.000	3.188	163
VM10-12	7.875		9.750	14.000	9.000	5.188	0.500	1.000	26.250	8.500	11.000	3.188	168	
VM10-14	7.875		9.750	15.375	10.250	5.188	0.500	1.000	29.438	8.500	11.000	3.188	220	
VM10-16	7.875	9.750	15.375	10.250	5.188	0.500	1.000	31.750	8.500	11.000	3.188	225		
VM10-18	7.875	9.750	15.375	10.250	5.188	0.500	1.000	34.188	8.500	11.000	3.188	236		
VM10-20	7.875	9.750	15.375	10.250	5.188	0.500	1.000	36.500	8.500	11.000	3.188	240		
VM10-22	7.875	9.750	15.375	10.250	5.188	0.500	1.000	38.875	8.500	11.000	3.188	245		

NOTES:

ALL DIMENSIONS ARE IN INCHES [MM] AND MAY VARY ±0.375 INCHES.

THIS DRAWING IS NOT TO BE USED FOR CONSTRUCTION UNLESS CERTIFIED BY AMERIFLO.

MODEL VM10 - SECTIONAL VIEW

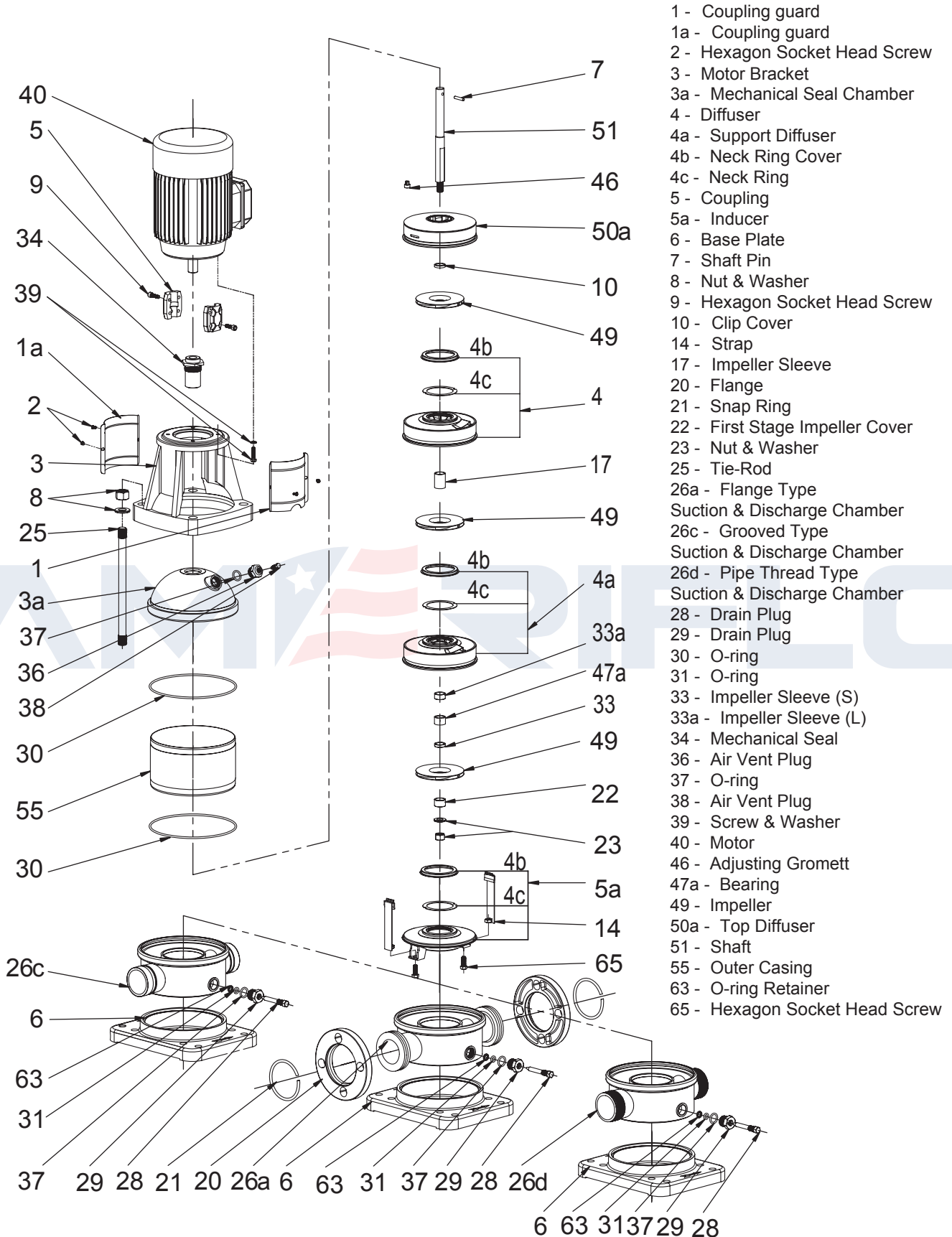

MODEL VM10 - SECTIONAL VIEW PART REFERENCE

ITEM NUMBER	PART NAME	MATERIAL	
		VM (304SS)	VM (316 SS)
1 & 1a	Coupling Guard	304 SS (EN 1.4301)	
2	Hexagon Socket Head Screw	A2-70 UNI 7323	
3	Motor Bracket	304 SS (EN 1.4301)	316 SS (EN 1.4401)
3a	Mechanical Seal Chamber		
4	Diffuser	304 SS (EN 1.4301)	316 SS (EN 1.4401)
4a	Support Diffuser	304 SS (EN 1.4301)	316 SS (EN 1.4401)
4b	Neck Ring Base Assembly	304 SS (EN 1.4301)	316 SS (EN 1.4401)
4c	Neck Ring	FPM	
5	Coupling	Die Cast Aluminum EN AB-AISI11Cu ₂ (Fe)	
5a	Inducer	304 SS (EN 1.4301)	316 SS (EN 1.4401)
6	Flanged Type Base Plate	Die Cast Aluminum EN AB-AISI11Cu ₂ (Fe)	
7	Shaft Pin	304 SS (EN 1.4301)	316 SS (EN 1.4401)
8	Nut (M8) & Washer (M8)	A2-70 UNI 7323	
9	Hexagon Socket Head Screw	A2-70 UNI 7323	
10	Clip Cover	304 SS (EN 1.4301)	316 SS (EN 1.4401)
20	Flange	Cast Iron	
21	Snap Ring	304 SS (EN 1.4301)	
22	First Stage Impeller Cover	304 SS (EN 1.4301)	316 SS (EN 1.4401)
23	Nut (M8) & Washer (M8)	A2-70 UNI 7323	
25	Tie-Rod	Galvanized Steel 6.8 Strength Class ISO 898/1	
26a	Flanged Type Suction & Discharge Chamber	304 SS (EN 1.4301)	316 SS (EN 1.4401)
26c	Grooved Type Suction & Discharge Chamber	304 SS (EN 1.4301)	316 SS (EN 1.4401)
26d	Pipie Thread Type Suction & Discharge Chamber	304 SS (EN 1.4301)	316 SS (EN 1.4401)
28	Drain Plug (M10)	304 SS (EN 1.4301)	316 SS (EN 1.4401)
29	Drain Plug	304 SS (EN 1.4301)	316 SS (EN 1.4401)
30	O-Ring	FPM	
31	O-Ring	FPM	
33	Impeller Sleeve (Small)	Tungsten Carbide	
33a	Impeller Sleeve (Large)	Tungsten Carbide	
34	Mechanical Seal	Silicon Carbide / Carbon / FPM	
36	Air Vent Plug	304 SS (EN 1.4301)	316 SS (EN 1.4401)
37	O-Ring	FPM	
38	Air Vent Plug	304 SS (EN 1.4301)	316 SS (EN 1.4401)
39	Screw & Washer	Galvanized Steel	
40	Motor	Refer To Motor Manufacturer	
46	Adjusting Gromett	FPM	
47a	Bearing	Tungsten Carbide	
49	Impeller	304 SS (EN 1.4301)	316 SS (EN 1.4401)
50a	Top Diffuser	304 SS (EN 1.4301)	316 SS (EN 1.4401)
51	Shaft	304 SS (EN 1.4301)	316 SS (EN 1.4401)
55	Outer Casing	304 SS (EN 1.4301)	316 SS (EN 1.4401)
63	O-ring Retainer	304 SS (EN 1.4301)	316 SS (EN 1.4401)
65	Hexagon Socket Head Screw	A2-70 UNI 7323	

MODEL VM10 - ENGINEERING INFORMATION

PUMP MODEL	OPERATING TEMPERATURE RANGE	MECHANICAL SEAL TYPE	MECHANICAL SEAL MATERIAL				
			ROTATING FACE	STATIONARY FACE	ELASTOMERS	SPRING	COLLAR
VM10	+5°F TO +248°F [-15°C TO +120°C]	BALANCED	SILICON CARBIDE	CARBON	FPM	316 SS	316 SS

RATED FLOW:	44 GPM [10 M ³ /HR]
FLOW RANGE:	26 - 66 GPM [6 - 15 M ³ /HR]
MAXIMUM PRESSURE:	363 PSI [25 BAR]
MAXIMUM POWER:	1 - 1.5 HP [0.75 - 1.1 KW]
MAXIMUM EFFICIENCY:	68%

