



4710 SERIES

VERTICAL MULTISTAGE PUMPS

VM2

ENGINEERING INFORMATION

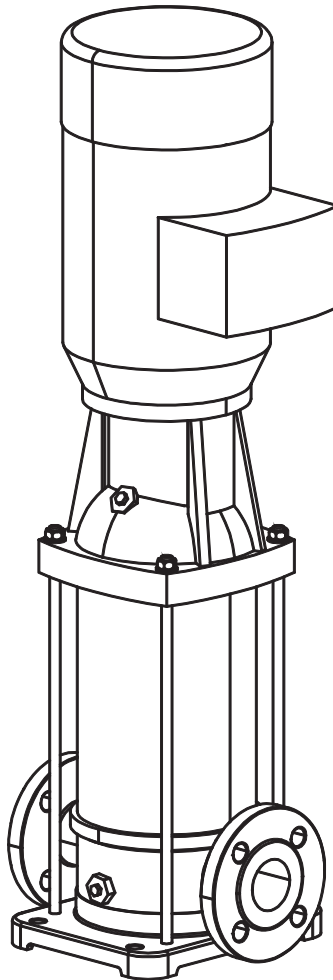

VM2 (1x1) 2900 RPM

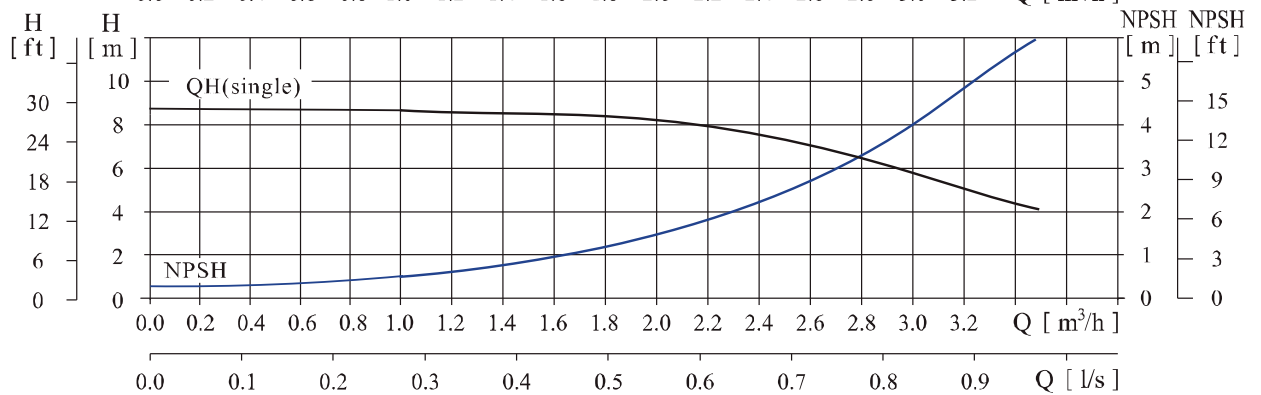
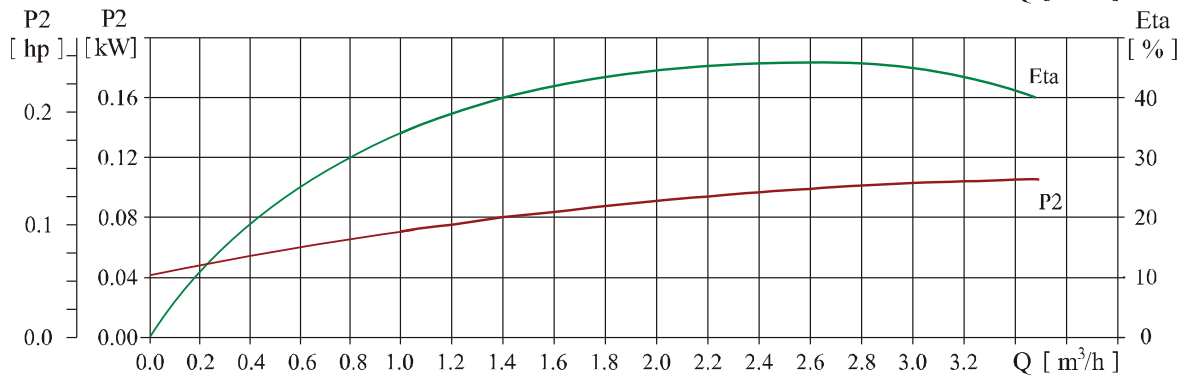
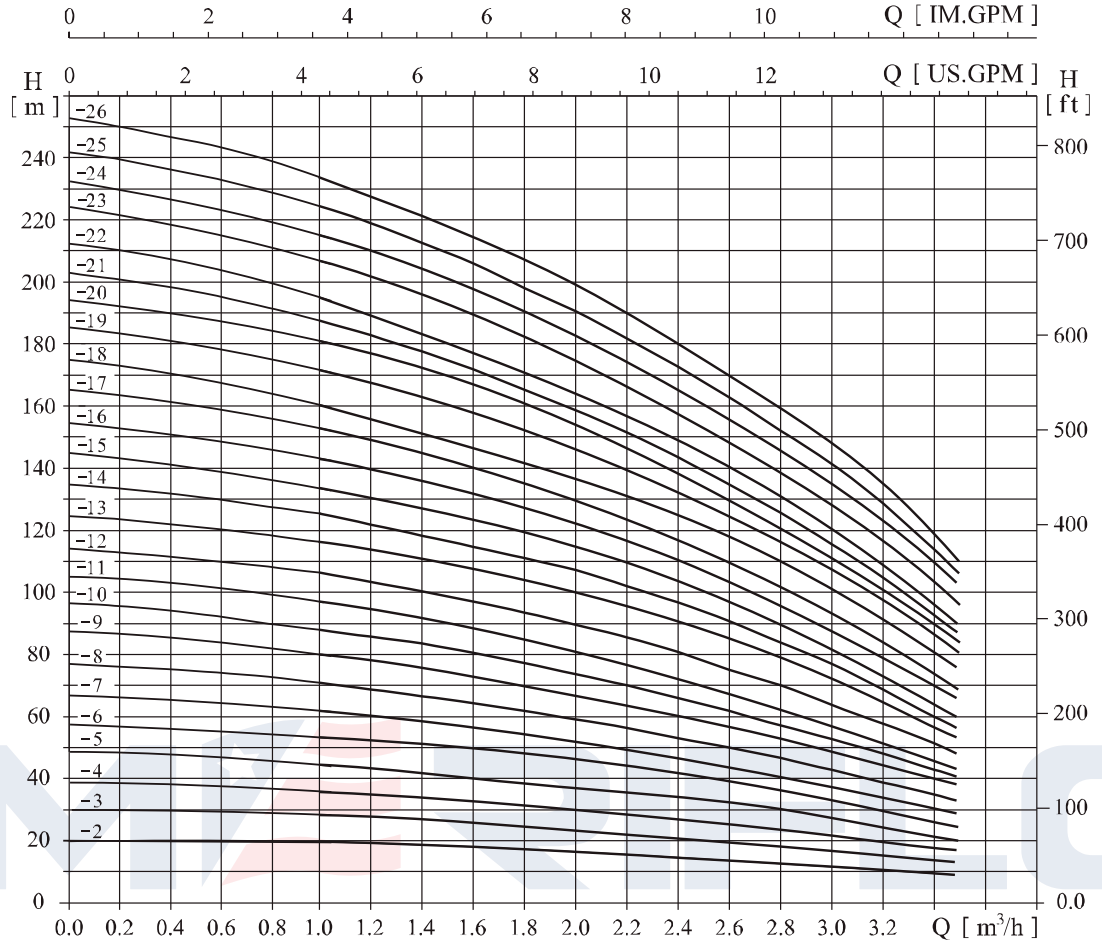
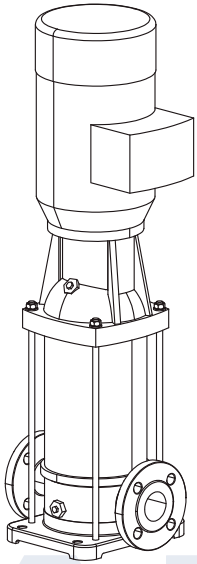

MODEL VM2 - PERFORMANCE TABLE (2900 RPM)

MODEL	SPEED	MOTOR	FLOW	2.5	5	7.5	10	12.5	15		
		HP	GPM								
VM2-2	2900	0.5	HEAD (PSI)	26	24	23	20	17	11		
VM2-3		0.5		38	37	34	30	26	17		
VM2-4		0.75		51	50	47	40	34	23		
VM2-5		0.75		64	61	57	50	43	28		
VM2-6		1		75	74	71	60	51	34		
VM2-7		1		89	87	81	77	58	40		
VM2-9		1.5		114	111	104	87	77	52		
VM2-11		1.5		139	135	126	104	91	63		
VM2-13		2		165	162	151	126	111	74		
VM2-15		2		190	185	175	142	128	85		
VM2-18		5		229	223	210	183	153	108		
VM2-22		5		280	273	256	222	185	128		
VM2-26		5		330	328	304	238	224	156		



VM2 (1x1) 3500 RPM

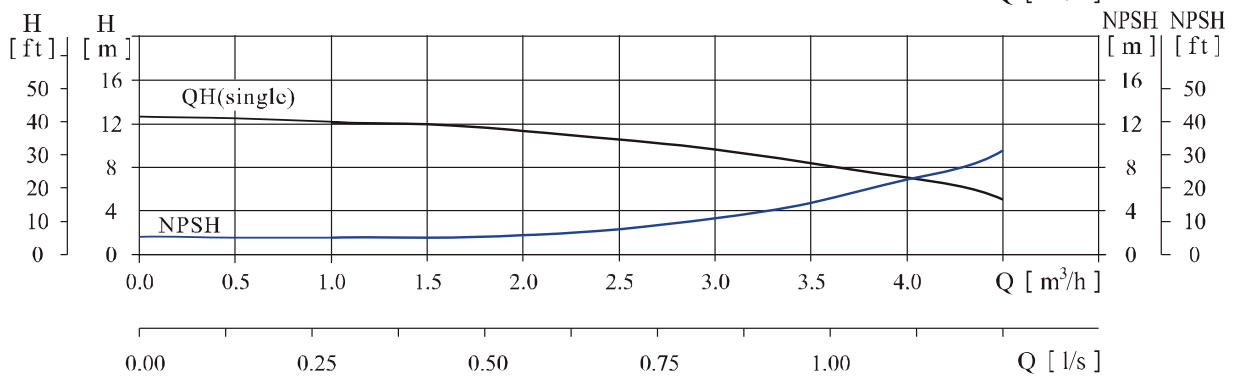
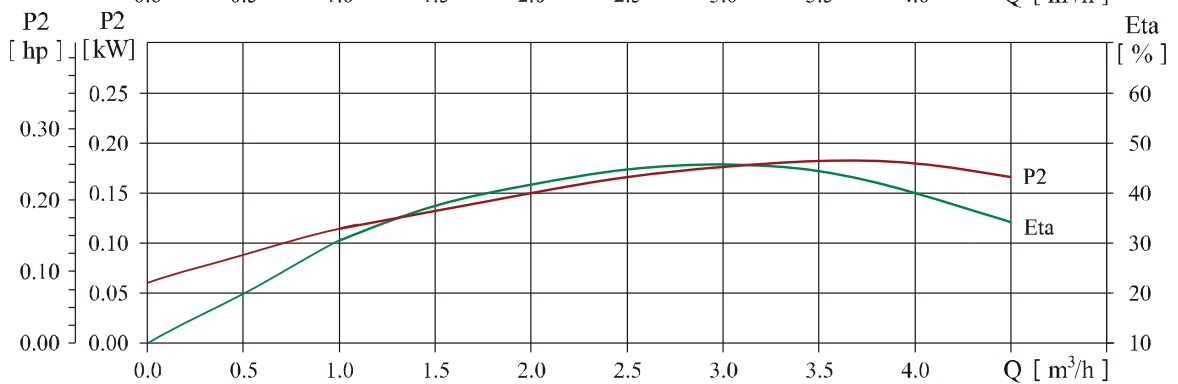
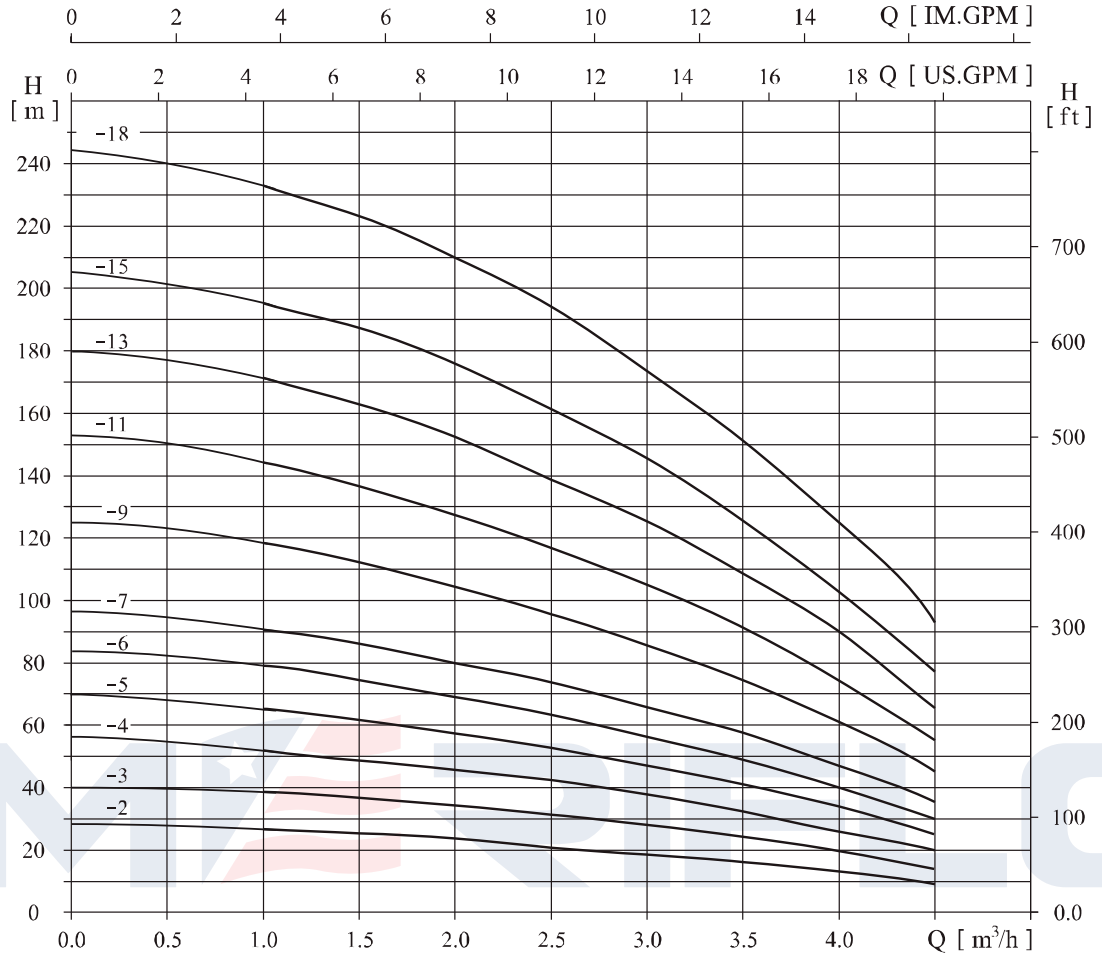
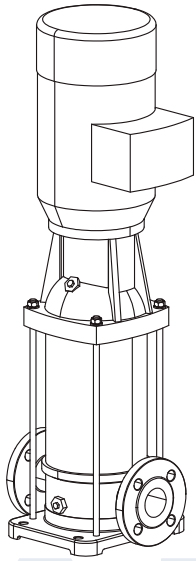

MODEL VM2 - PERFORMANCE TABLE (3500 RPM)

MODEL	SPEED	MOTOR	FLOW	2.5	5	7.5	10	12.5	15	17.5	20
		HP	GPM								
VM2-2	3500	0.75	HEAD (PSI)	37	34	31	30	26	23	17	13
VM2-3		1		55	51	47	44	38	34	27	21
VM2-4		1.5		74	68	64	60	51	45	37	28
VM2-5		1.5		92	85	81	74	65	58	45	36
VM2-6		1.5		111	105	98	89	80	70	57	43
VM2-7		2		129	122	115	105	94	81	67	50
VM2-9		3		166	158	148	135	122	107	87	64
VM2-11		3		203	193	182	165	148	128	107	80
VM2-13		5		243	232	216	197	179	153	128	94
VM2-15		5		277	264	250	227	202	178	146	109
VM2-18		7.5		332	324	301	277	243	214	178	134

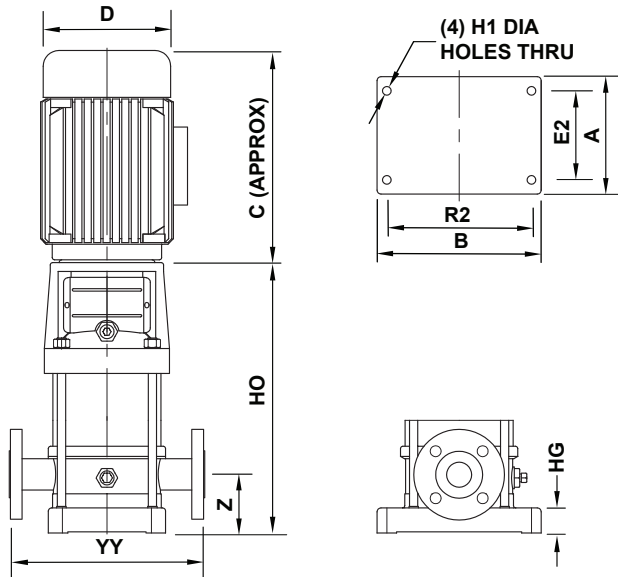

AMERIFLO**MODEL VM2 - VERTICAL MULTISTAGE, ELECTRIC NEMA MOTOR****GENERAL ARRANGEMENT DRAWING**

FLANGE DRILLING STANDARD & DETAILS						
SUCT	250# ANSI		DISC	250# ANSI		
	SIZE	RF DIA	P.C.D	# HOLES	SIZE	
SUCT	1.00	2.000	3.500	4	0.625	
DISC	1.00	2.000	3.500	4	0.625	
FORCES (LBS) & MOMENTS (LB-FEET)						
	Fx	Fy	Fz	Mx	My	Mz
SUCT	160	130	200	340	170	260
DISC	160	130	200	340	170	260

VM2

MODEL	SPEED	A	B	C	D	E2	H1	HG	HO	R2	YY	Z	WEIGHT
	RPM												LBS
VM2-2	2900 3500	5.938	8.250	8.875	5.875	3.938	0.500	1.250	10.188	7.000	9.813	3.000	44
VM2-3		5.938	8.250	8.875	5.875	3.938	0.500	1.250	10.875	7.000	9.813	3.000	44
VM2-4		5.938	8.250	8.875	5.875	3.938	0.500	1.250	11.625	7.000	9.813	3.000	49
VM2-5		5.938	8.250	8.875	5.875	3.938	0.500	1.250	12.250	7.000	9.813	3.000	51
VM2-6		5.938	8.250	9.625	6.688	3.938	0.500	1.250	13.375	7.000	9.813	3.000	57
VM2-7		5.938	8.250	9.625	6.688	3.938	0.500	1.250	14.000	7.000	9.813	3.000	57
VM2-9		5.938	8.250	9.625	6.688	3.938	0.500	1.250	15.500	7.000	9.813	3.000	62
VM2-11		5.938	8.250	9.625	6.688	3.938	0.500	1.250	16.938	7.000	9.813	3.000	64
VM2-13		5.938	8.250	11.413	7.500	3.938	0.500	1.250	18.750	7.000	9.813	3.000	77
VM2-15		5.938	8.250	11.413	7.500	3.938	0.500	1.250	20.188	7.000	9.813	3.000	79
VM2-18		5.938	8.250	11.413	7.500	3.938	0.500	1.250	22.250	7.000	9.813	3.000	90
VM2-22		5.938	8.250	11.413	7.500	3.938	0.500	1.250	25.188	7.000	9.813	3.000	93
VM2-26		5.938	8.250	13.625	7.750	3.938	0.500	1.250	28.375	7.000	9.813	3.000	115

NOTES:ALL DIMENSIONS ARE IN INCHES [MM] AND MAY VARY ± 0.375 INCHES.

THIS DRAWING IS NOT TO BE USED FOR CONSTRUCTION UNLESS CERTIFIED BY AMERIFLO.

MODEL VM2 - SECTIONAL VIEW

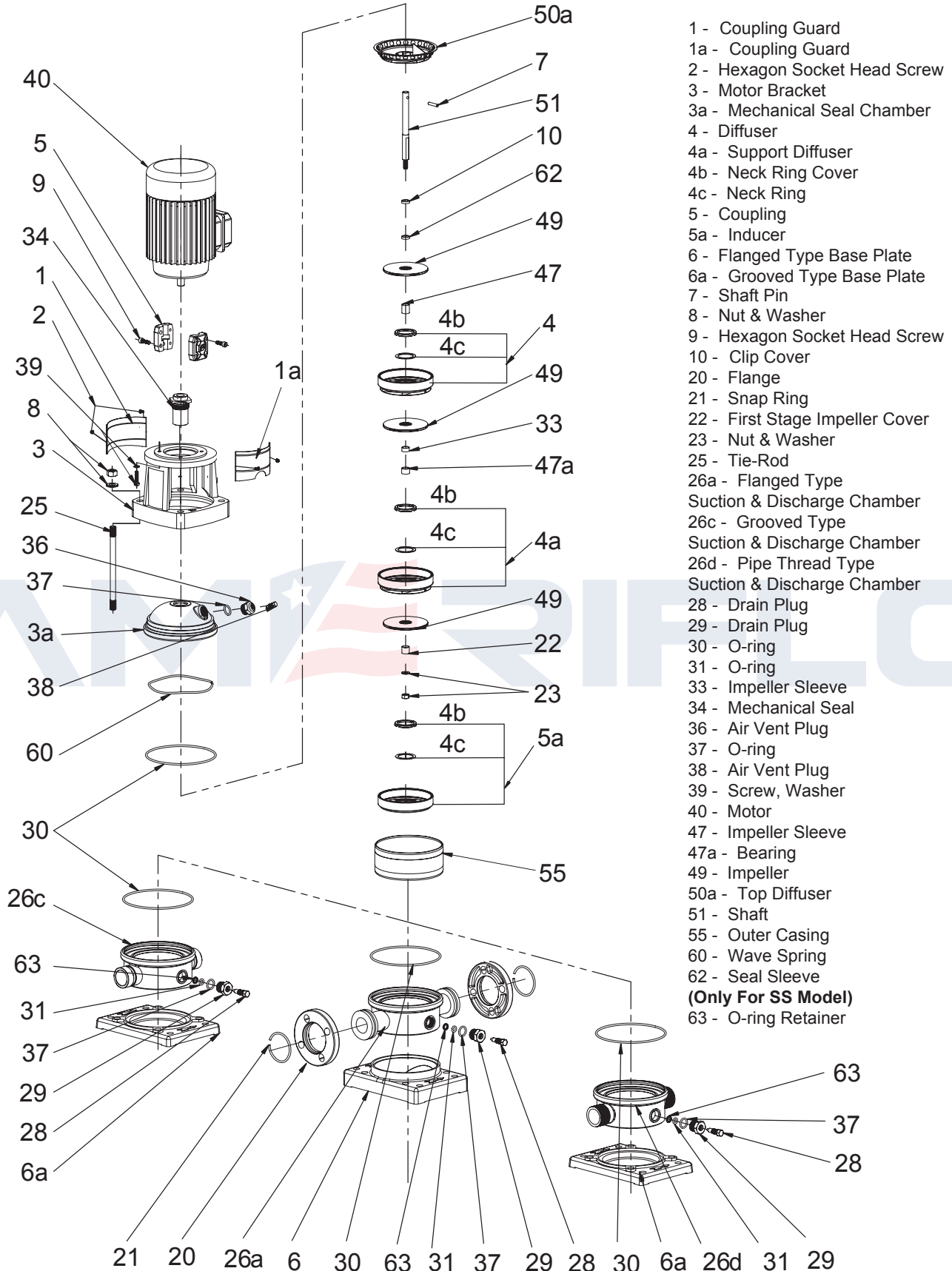

MODEL VM2 - SECTIONAL VIEW PART REFERENCE

ITEM NUMBER	PART NAME	MATERIAL	
		VM (304SS)	VM (316 SS)
1 & 1a	Coupling Guard	304 SS (EN 1.4301)	
2	Hexagon Socket Head Screw	A2-70 UNI 7323	
3	Motor Bracket	304 SS (EN 1.4301)	316 SS (EN 1.4401)
3a	Mechanical Seal Chamber		
4	Diffuser	304 SS (EN 1.4301)	316 SS (EN 1.4401)
4a	Support Diffuser	304 SS (EN 1.4301)	316 SS (EN 1.4401)
4b	Neck Ring Base Assembly	304 SS (EN 1.4301)	316 SS (EN 1.4401)
5	Coupling	Die Cast Aluminum EN AB-AISI11Cu ₂ (Fe)	
5a	Inducer	304 SS (EN 1.4301)	316 SS (EN 1.4401)
6	Flanged Type Base Plate	Die Cast Aluminum EN AB-AISI11Cu ₂ (Fe)	
6a	Grooved Type Base Plate	Die Cast Aluminum EN AB-AISI11Cu ₂ (Fe)	
7	Shaft Pin	304 SS (EN 1.4301)	316 SS (EN 1.4401)
8	Nut (M8) & Washer (M8)	A2-70 UNI 7323	
9	Hexagon Socket Head Screw	A2-70 UNI 7323	
10	Clip Cover	304 SS (EN 1.4301)	316 SS (EN 1.4401)
20	Flange	Cast Iron	
21	Snap Ring	304 SS (EN 1.4301)	
22	First Stage Impeller Cover	304 SS (EN 1.4301)	316 SS (EN 1.4401)
23	Nut (M8) & Washer (M8)	A2-70 UNI 7323	
25	Tie-Rod	Galvanized Steel 6.8 Strength Class ISO 898/1	
26a	Flanged Type Suction & Discharge Chamber	304 SS (EN 1.4301)	316 SS (EN 1.4401)
26c	Grooved Type Suction & Discharge Chamber	304 SS (EN 1.4301)	316 SS (EN 1.4401)
26d	Pipie Thread Type Suction & Discharge Chamber	304 SS (EN 1.4301)	316 SS (EN 1.4401)
28	Drain Plug (M10)	304 SS (EN 1.4301)	316 SS (EN 1.4401)
29	Drain Plug	304 SS (EN 1.4301)	316 SS (EN 1.4401)
30	O-Ring	FPM	
31	O-Ring	FPM	
33	Impeller Sleeve	Tungsten Carbide	
34	Mechanical Seal	Silicon Carbide / Carbon / FPM	
36	Air Vent Plug	304 SS (EN 1.4301)	316 SS (EN 1.4401)
37	O-Ring	FPM	
38	Air Vent Plug	304 SS (EN 1.4301)	316 SS (EN 1.4401)
39	Screw & Washer	Galvanized Steel	
40	Motor	Refer To Motor Manufacturer	
47	Impeller Sleeve	Tungsten Carbide	
47a	Bearing	Tungsten Carbide	
49	Impeller	304 SS (EN 1.4301)	316 SS (EN 1.4401)
50a	Top Diffuser	304 SS (EN 1.4301)	316 SS (EN 1.4401)
51	Shaft	304 SS (EN 1.4301)	316 SS (EN 1.4401)
55	Outer Casing	304 SS (EN 1.4301)	316 SS (EN 1.4401)
60	Wave Spring	A2-70 UNI 7323	
62	Seal Sleeve	Tungsten Carbide	
63	O-ring Retainer	304 SS (EN 1.4301)	316 SS (EN 1.4401)

MODEL VM2 - ENGINEERING INFORMATION

PUMP MODEL	OPERATING TEMPERATURE RANGE	MECHANICAL SEAL TYPE	MECHANICAL SEAL MATERIAL				
			ROTATING FACE	STATIONARY FACE	ELASTOMERS	SPRING	COLLAR
VM2	+5°F TO +248°F [-15°C TO +120°C]	BALANCED	SILICON CARBIDE	CARBON	FPM	316 SS	316 SS

RATED FLOW:	8.8 GPM [2 M ³ /HR]
FLOW RANGE:	4.4 - 19.8 GPM [1 - 4.5 M ³ /HR]
MAXIMUM PRESSURE:	341 PSI [23.5 BAR]
MAXIMUM POWER:	0.75 - 4 HP [0.55 - 5 KW]
MAXIMUM EFFICIENCY:	46%

