



## 4710 SERIES

### VERTICAL MULTISTAGE PUMPS

#### VM200

### ENGINEERING INFORMATION

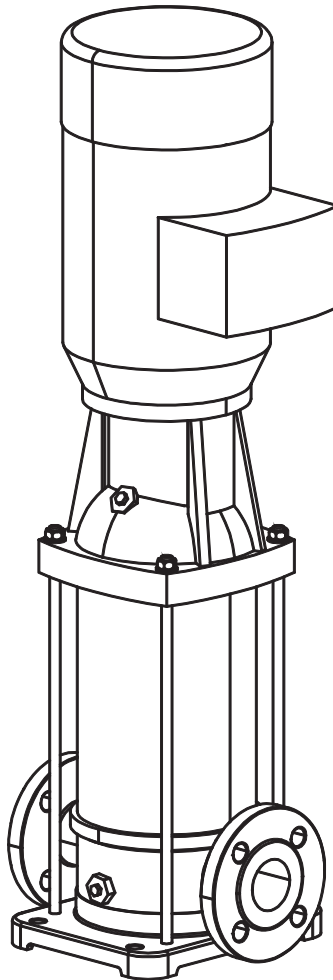

# VM200 (6x6) 2900 RPM

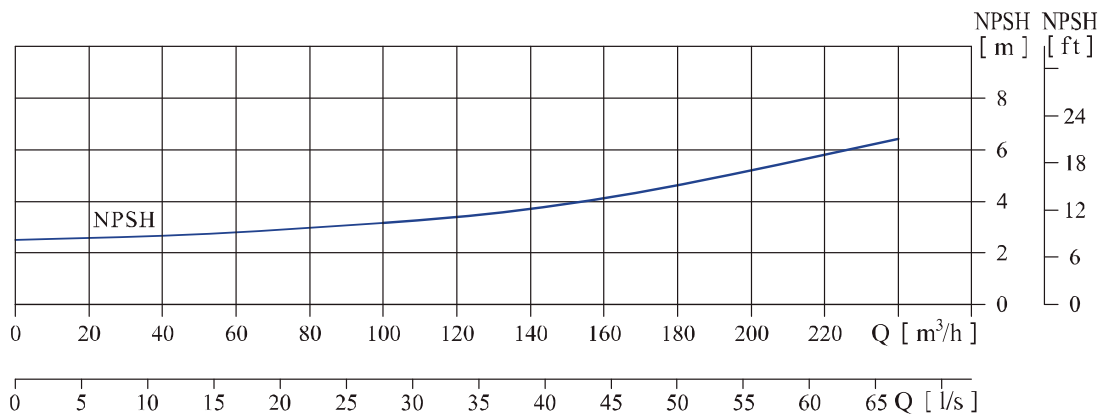
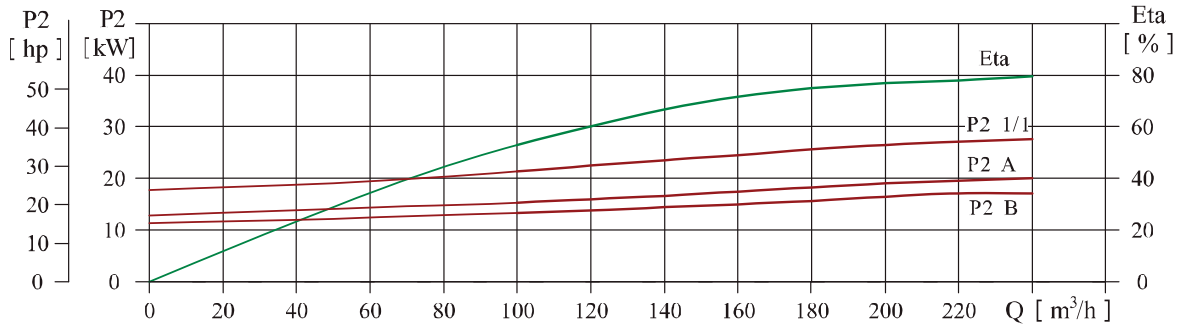
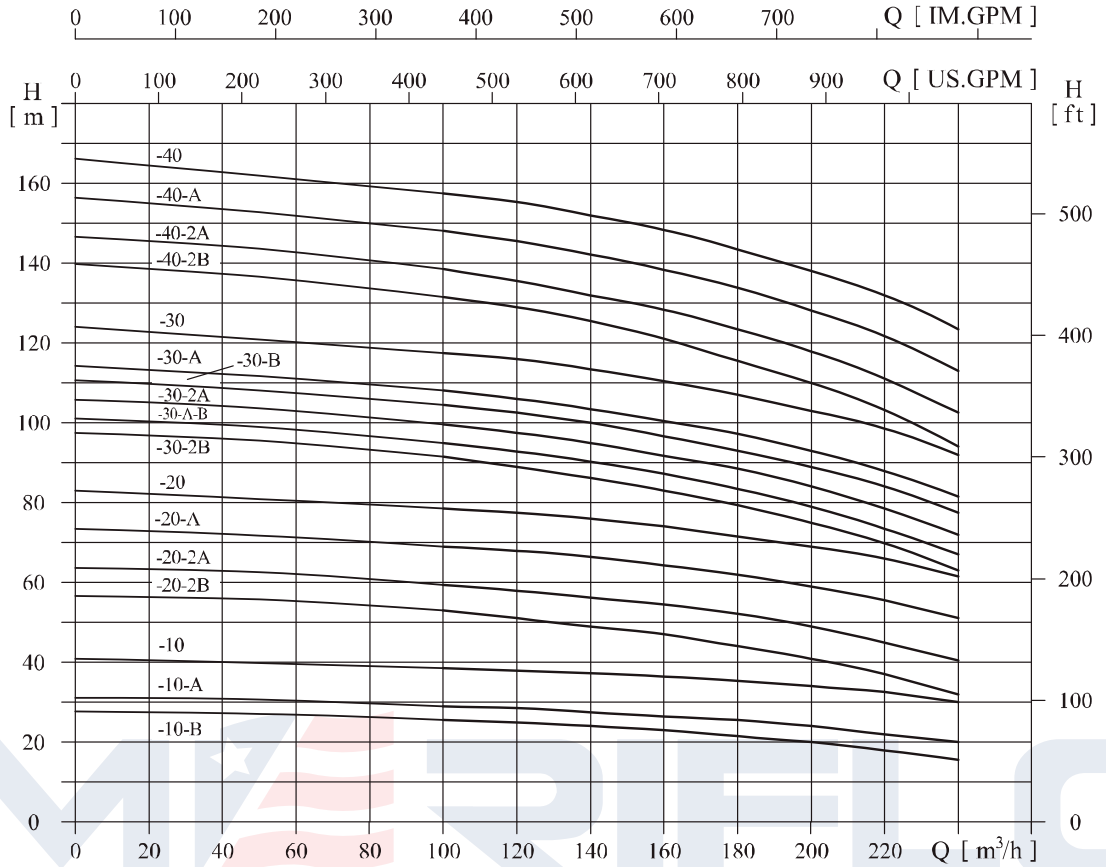
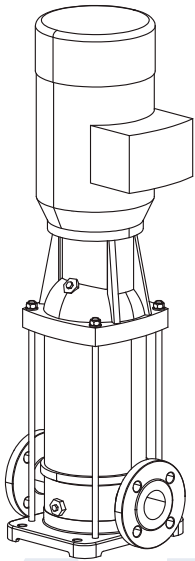

**MODEL VM200 - PERFORMANCE TABLE (2900 RPM)**

MODEL	SPEED	MOTOR	FLOW	500	600	700	800	900	950	1050
		HP	GPM							
VM200-10-B	2900	25	HEAD (PSI)	36	34	33	31	28	26	23
VM200-10-A		30		41	40	36	37	34	31	28
VM200-10		40		54	54	53	50	48	47	43
VM200-20-2B		50		72	70	67	62	48	53	45
VM200-20-2A		60		82	80	77	75	70	64	58
VM200-20-A		75		97	94	91	88	84	80	72
VM200-20		75		111	108	105	102	98	94	88
VM200-30-2B		100		126	124	119	112	107	99	89
VM200-30-A-B		100		132	128	124	119	112	105	95
VM200-30-2A		100		139	135	131	126	119	112	102
VM200-30-B		100		146	142	138	132	126	121	111
VM200-30-A		100		151	148	143	139	132	125	116
VM200-30		125		165	162	158	152	146	141	131
VM200-40-2B		125		183	179	172	165	156	148	134
VM200-40-2A		150		193	187	182	176	168	158	146
VM200-40-A		150		207	203	196	190	182	173	160
VM200-40		150		222	217	210	205	196	189	176



# VM200 (6x6) 3500 RPM

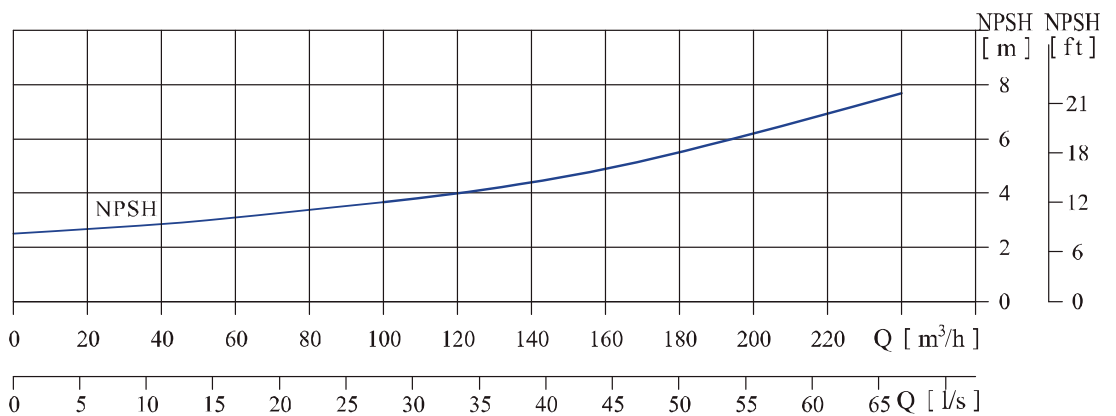
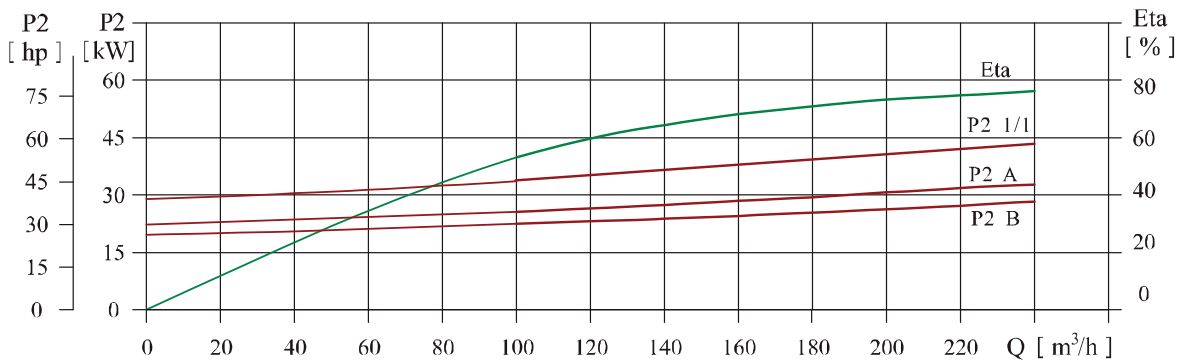
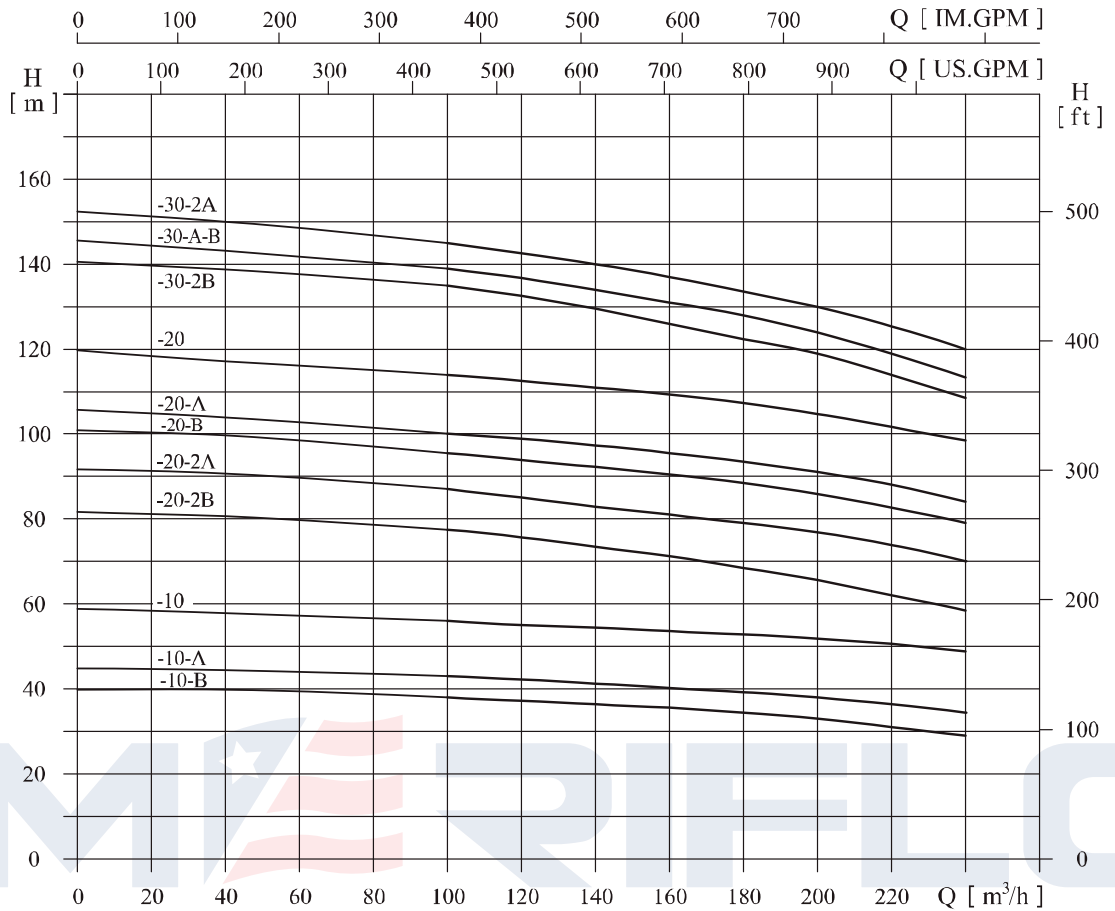
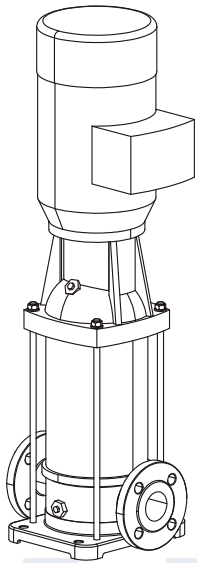

**MODEL VM200 - PERFORMANCE TABLE (3500 RPM)**

MODEL	SPEED	MOTOR	FLOW	500	600	700	800	900	950	1050
		HP	GPM							
VM200-10-B	3500	40	HEAD (PSI)	53	53	51	48	47	44	41
VM200-10-A		50		60	60	57	55	54	53	50
VM200-10		60		78	78	77	75	74	72	70
VM200-20-2B		75		108	105	101	98	94	88	84
VM200-20-2A		100		121	118	115	112	109	105	99
VM200-20-B		100		134	132	129	126	122	118	112
VM200-20-A		125		141	139	136	134	129	125	119
VM200-20		125		160	158	156	153	149	145	141
VM200-30-2B		150		189	185	179	175	169	162	162
VM200-30-A-B		150		195	190	186	182	176	169	162
VM200-30-2A		150		203	199	195	190	185	179	170



**AMERIFLO**

# MODEL VM200 - VERTICAL MULTISTAGE, ELECTRIC NEMA MOTOR GENERAL ARRANGEMENT DRAWING

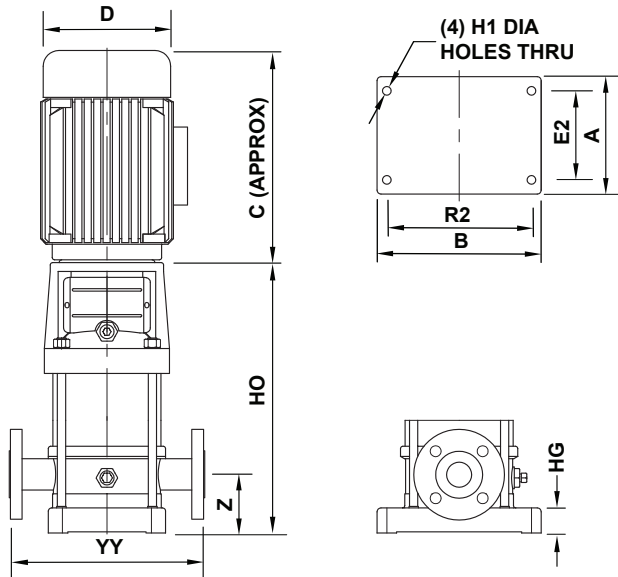

FLANGE DRILLING STANDARD & DETAILS						
SUCT	250# ANSI		DISC	250# ANSI		
	SIZE	RF DIA	P.C.D	# HOLES	SIZE	
SUCT	6	6.188	8.500	12	0.750	
DISC	6	6.188	8.500	12	0.750	
FORCES (LBS) & MOMENTS (LB-FEET)						
	Fx	Fy	Fz	Mx	My	Mz
SUCT	800	950	1100	1250	1400	1400
DISC	800	950	1100	1250	1400	1400

## VM200

MODEL	SPEED RPM	A	B	C	D	E2	H1	HG	HO	R2	YY	Z	WEIGHT
													LBS
VM200-10	2900	18.125	23.625	25.625	12.250	15.188	0.750	1.500	35.750	19.688	19.250	7.875	888
VM200-20		18.125	23.625	29.938	21.250	15.188	0.750	1.500	44.500	19.688	19.250	7.875	1312
VM200-30	3500	18.125	23.625	35.250	22.813	15.188	0.750	1.500	52.188	19.688	19.250	7.875	1801
VM200-40		18.125	23.625	44.875	25.375	15.188	0.750	1.500	59.813	19.688	19.250	7.875	2601

### NOTES:

ALL DIMENSIONS ARE IN INCHES [MM] AND MAY VARY  $\pm 0.375$  INCHES.

THIS DRAWING IS NOT TO BE USED FOR CONSTRUCTION UNLESS CERTIFIED BY AMERIFLO.

**MODEL VM200 - SECTIONAL VIEW**

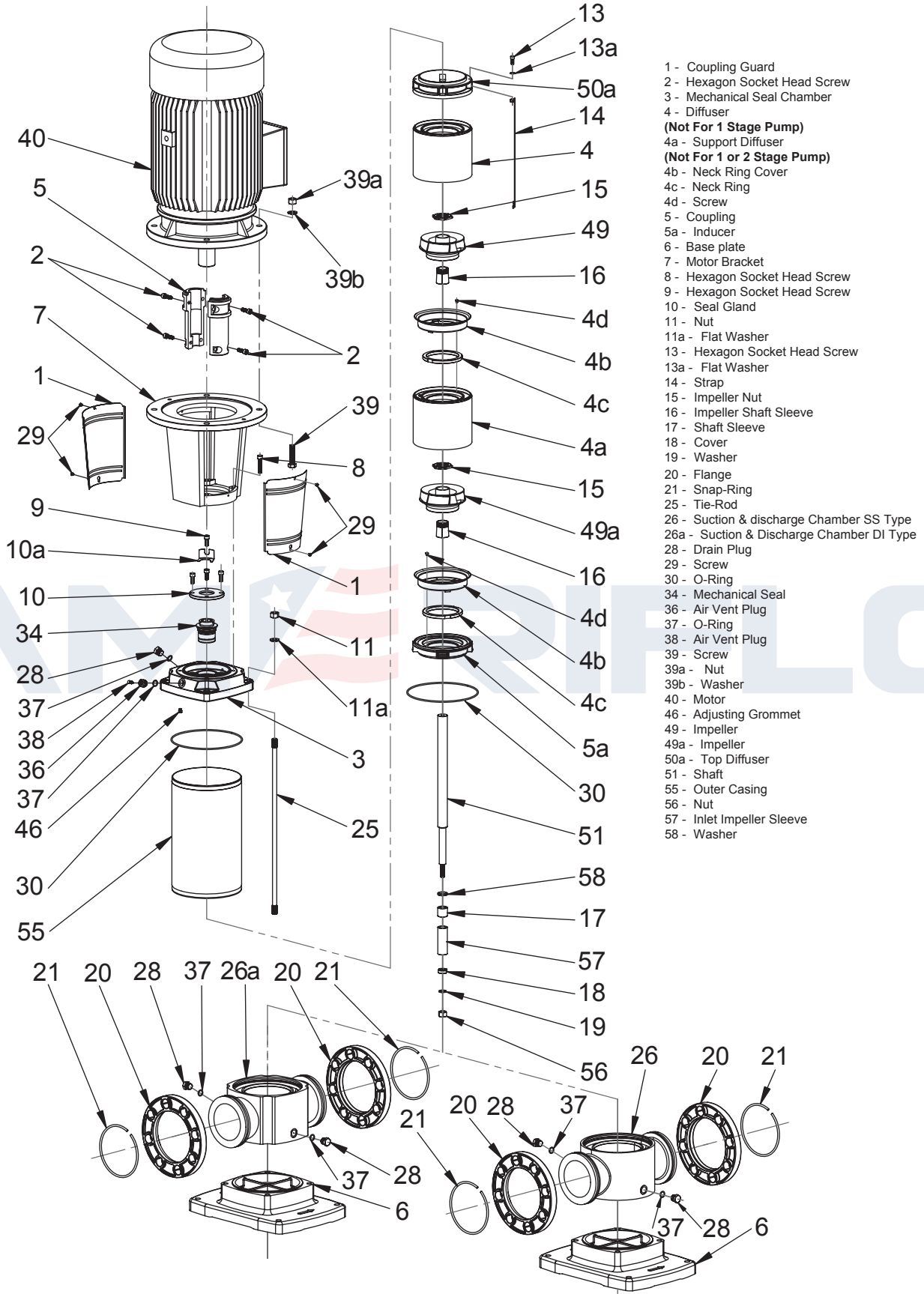

- 1 - Coupling Guard
- 2 - Hexagon Socket Head Screw
- 3 - Mechanical Seal Chamber
- 4 - Diffuser
- (Not For 1 Stage Pump)
- 4a - Support Diffuser
- (Not For 1 or 2 Stage Pump)
- 4b - Neck Ring Cover
- 4c - Neck Ring
- 4d - Screw
- 5 - Coupling
- 5a - Inducer
- 6 - Base plate
- 7 - Motor Bracket
- 8 - Hexagon Socket Head Screw
- 9 - Hexagon Socket Head Screw
- 10 - Seal Gland
- 11 - Nut
- 11a - Flat Washer
- 13 - Hexagon Socket Head Screw
- 13a - Flat Washer
- 14 - Strap
- 15 - Impeller Nut
- 16 - Impeller Shaft Sleeve
- 17 - Shaft Sleeve
- 18 - Cover
- 19 - Washer
- 20 - Flange
- 21 - Snap-Ring
- 25 - Tie-Rod
- 26 - Suction & discharge Chamber SS Type
- 26a - Suction & Discharge Chamber DI Type
- 28 - Drain Plug
- 29 - Screw
- 30 - O-Ring
- 34 - Mechanical Seal
- 36 - Air Vent Plug
- 37 - O-Ring
- 38 - Air Vent Plug
- 39 - Screw
- 39a - Nut
- 39b - Washer
- 40 - Motor
- 46 - Adjusting Grommet
- 49 - Impeller
- 49a - Impeller
- 50a - Top Diffuser
- 51 - Shaft
- 55 - Outer Casing
- 56 - Nut
- 57 - Inlet Impeller Sleeve
- 58 - Washer

**MODEL VM200 - SECTIONAL VIEW PART REFERENCE**

ITEM NUMBER	PART NAME	MATERIAL	
		VM (304SS)	VM (316 SS)
1	Coupling Guard	304 SS (EN 1.4301)	
2	Hexagon Socket Head Screw	A2-70 UNI 7323	
3	Pump Head	304 SS (EN 1.4301)	316 SS (EN 1.4401)
4	Diffuser	304 SS (EN 1.4301)	316 SS (EN 1.4401)
4a	Support Diffuser	304 SS (EN 1.4301)	316 SS (EN 1.4401)
4b	Neck Ring Base Assembly	304 SS (EN 1.4301)	316 SS (EN 1.4401)
4c	Neck Ring	FPM	
5	Coupling	Die Cast Aluminum EN AB-AISI11Cu <sub>2</sub> (Fe)	
5a	Inducer	304 SS (EN 1.4301)	316 SS (EN 1.4401)
6	Base Plate	Die Cast Aluminum EN AB-AISI11Cu <sub>2</sub> (Fe)	
7	Motor Bracket	Cast Iron EN-GJL-200-EN 1561	
8	Hexagon Socket Head Screw	A2-70 UNI 7323	
9	Hexagon Socket Head Screw	A2-70 UNI 7323	
10	Seal Gland	304 SS (EN 1.4301)	316 SS (EN 1.4401)
11	Nut	Galvanized Steel	
11a	Flat Washer	Galvanized Steel	
13	Hexagon Socket Head Screw	A2-70 UNI 7323	
13a	Flat Washer	304 SS (EN 1.4301)	316 SS (EN 1.4401)
14	Strap	304 SS (EN 1.4301)	316 SS (EN 1.4401)
15	Impeller Nut	A2-70 UNI 7323	A4-70 UNI 7323
16	Collet	A2-70 UNI 7323	A4-70 UNI 7323
17	Intermediate Bearing	Tungsten Carbide	
18	Cover	304 SS (EN 1.4301)	316 SS (EN 1.4401)
19	Flat Washer	304 SS (EN 1.4301)	316 SS (EN 1.4401)
20	Flange	Cast Iron	
21	Snap Ring	304 SS (EN 1.4301)	
25	Tie-Rod	Galvanized Steel 6.8 Strength Class ISO 898/1	
26	VM Suction & Discharge Chamber	304 SS (EN 1.4301)	316 SS (EN 1.4401)
26a	VMF Suction & Discharge Chamber	304 SS (EN 1.4301)	316 SS (EN 1.4401)
28	Drain Plug (M10)	304 SS (EN 1.4301)	316 SS (EN 1.4401)
29	Drain Plug	304 SS (EN 1.4301)	316 SS (EN 1.4401)
30	O-Ring	FPM	
34	Mechanical Seal	Silicon Carbide / Carbon / FPM	
36	Air Vent Plug	304 SS (EN 1.4301)	316 SS (EN 1.4401)
37	O-Ring	FPM	
38	Air Vent Plug	304 SS (EN 1.4301)	316 SS (EN 1.4401)
39	Screw	Galvanized Steel	
39a	Nut	Galvanized Steel	
39b	Washer	Galvanized Steel	
40	Motor	Refer To Motor Manufacturer	
46	Adjusting Grommet	FPM	
49	Impeller	304 SS (EN 1.4301)	316 SS (EN 1.4401)
49a	Impeller	304 SS (EN 1.4301)	316 SS (EN 1.4401)
49b	Ring For Neck Ring	FPM	
50a	Top Diffuser	304 SS (EN 1.4301)	316 SS (EN 1.4401)
51	Shaft	304 SS (EN 1.4301)	316 SS (EN 1.4401)
55	Outer Casing	304 SS (EN 1.4301)	316 SS (EN 1.4401)
56	Nut	A2-70 UNI 7323	
57	Impeller Sleeve	Tungsten Carbide	
58	Washer	A2-70 UNI 7323	



**MODEL VM200 - ENGINEERING INFORMATION**

PUMP MODEL	OPERATING TEMPERATURE RANGE	MECHANICAL SEAL TYPE	MECHANICAL SEAL MATERIAL				
			ROTATING FACE	STATIONARY FACE	ELASTOMERS	SPRING	COLLAR
VM200	+5°F TO +248°F [-15°C TO +120°C]	BALANCED	SILICON CARBIDE	CARBON	FPM	316 SS	316 SS

<b>RATED FLOW:</b>	881 GPM [200 M <sup>3</sup> /HR]
<b>FLOW RANGE:</b>	440 - 1057 GPM [100 - 240 M <sup>3</sup> /HR]
<b>MAXIMUM PRESSURE:</b>	218 PSI [15 BAR]
<b>MAXIMUM POWER:</b>	40 - 125 HP [30 - 110 KW]
<b>MAXIMUM EFFICIENCY:</b>	79%

