

4710 SERIES

VERTICAL MULTISTAGE PUMPS

VM3

ENGINEERING INFORMATION

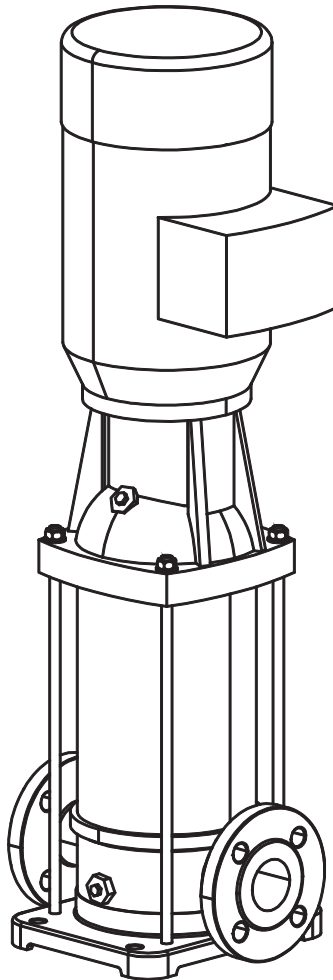

VM3 (1x1) 2900 RPM

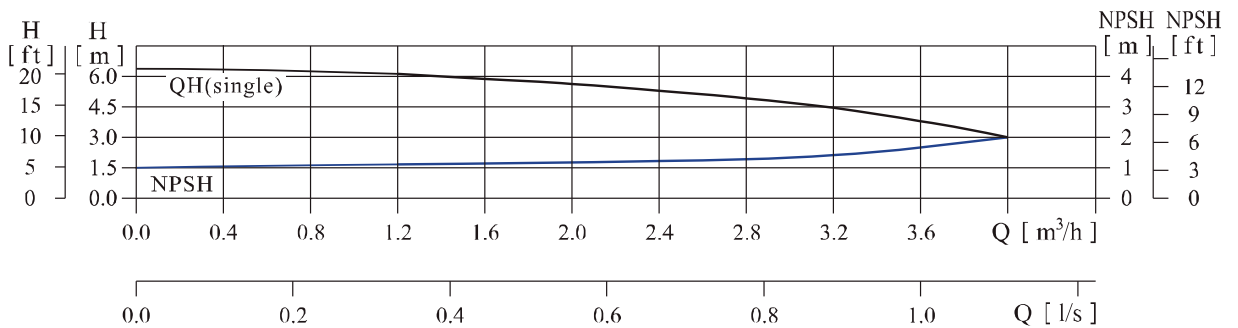
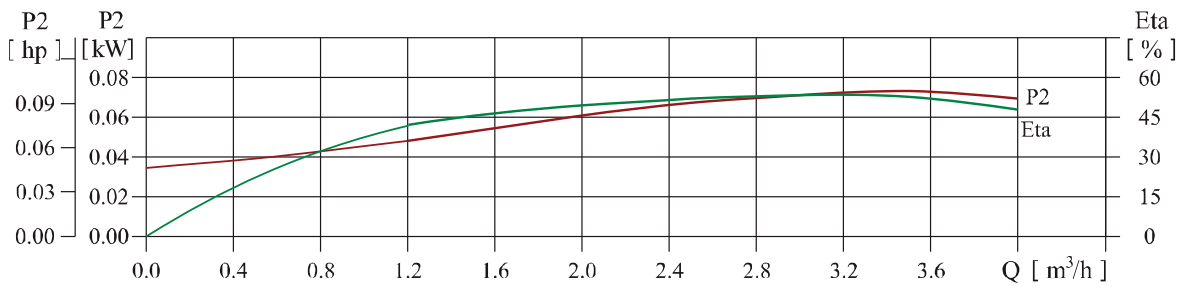
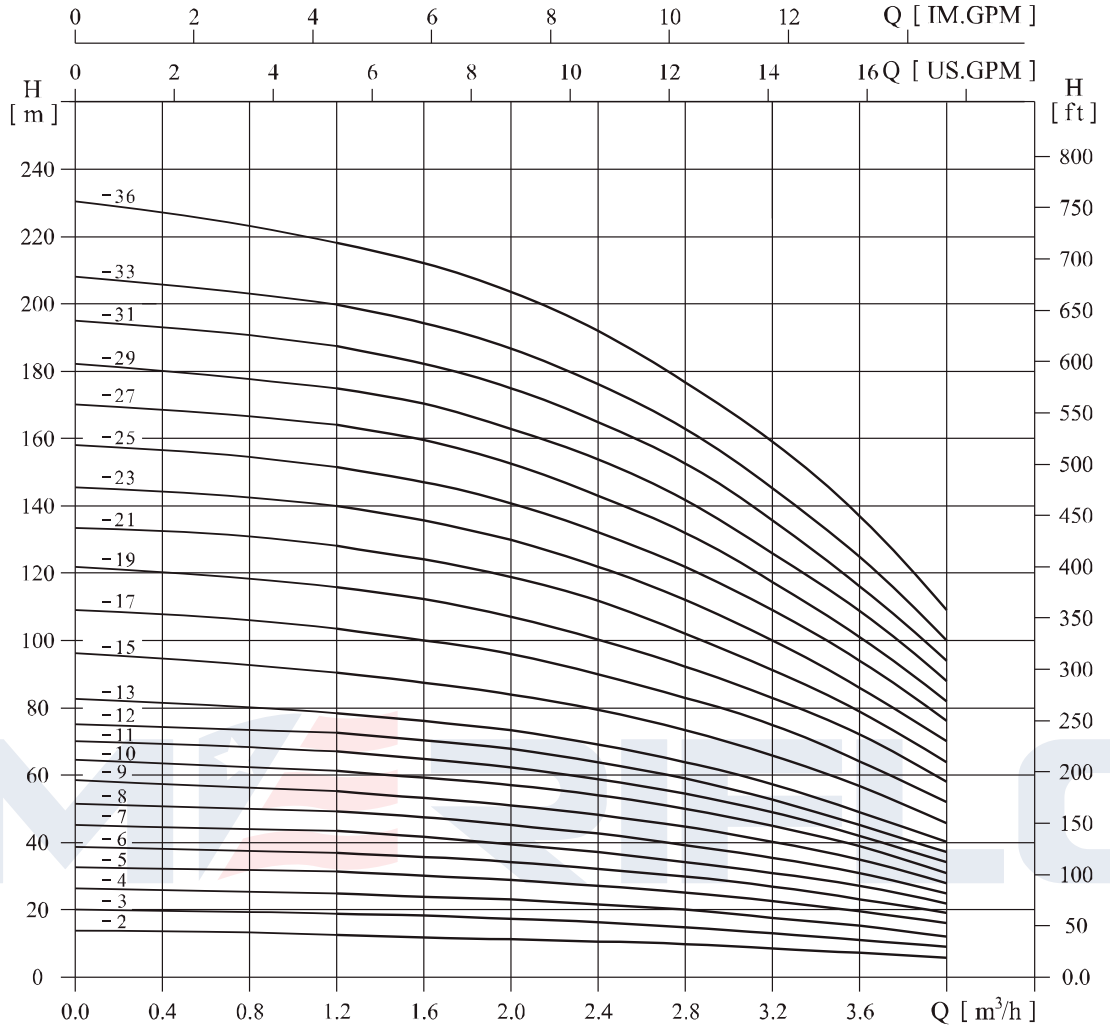
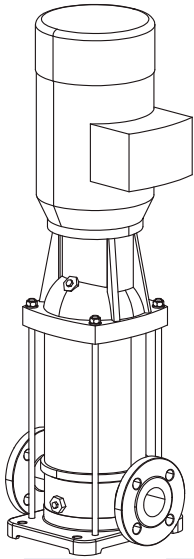

MODEL VM3 - PERFORMANCE TABLE (2900 RPM)

MODEL	SPEED	MOTOR	FLOW	5	7.5	10	12.5	15	17.5		
		HP	GPM								
VM3-2	2900	0.5	HEAD (PSI)	18	16	15	14	10	9		
VM3-3		0.5		27	26	23	21	16	13		
VM3-4		0.5		36	34	31	28	21	17		
VM3-5		0.5		44	43	38	36	27	23		
VM3-6		0.75		51	50	45	43	33	27		
VM3-7		0.75		61	58	53	48	38	31		
VM3-8		1		70	67	61	55	44	36		
VM3-9		1		78	75	68	64	50	40		
VM3-10		1		87	84	77	71	55	44		
VM3-11		1.5		95	91	82	77	60	48		
VM3-12		1.5		104	99	89	82	64	53		
VM3-13		1.5		111	108	98	91	70	57		
VM3-15		1.5		128	125	112	104	81	65		
VM3-17		2		146	142	128	118	91	74		
VM3-19		2		163	159	142	131	102	82		
VM3-21		3		182	176	159	145	112	91		
VM3-23		3		199	192	173	159	122	99		
VM3-25		3		214	209	186	173	134	108		
VM3-27		3		233	226	203	187	143	116		
VM3-29		3		249	241	217	202	155	125		
VM3-31	5	266	258	234	217	165	134				
VM3-33	5	283	276	250	232	178	142				
VM3-36	5	310	301	273	253	195	155				

VM3 (1x1) 3500 RPM

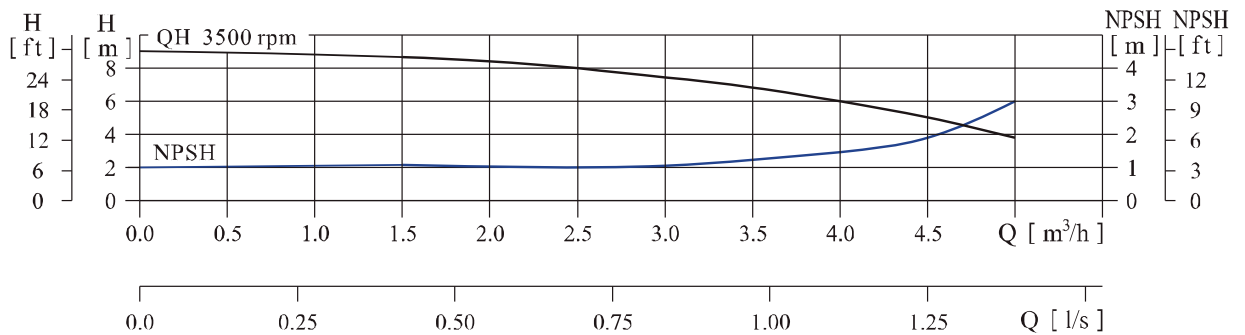
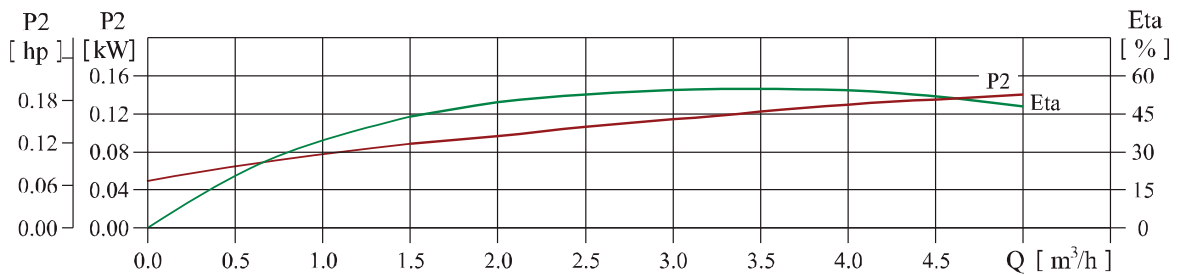
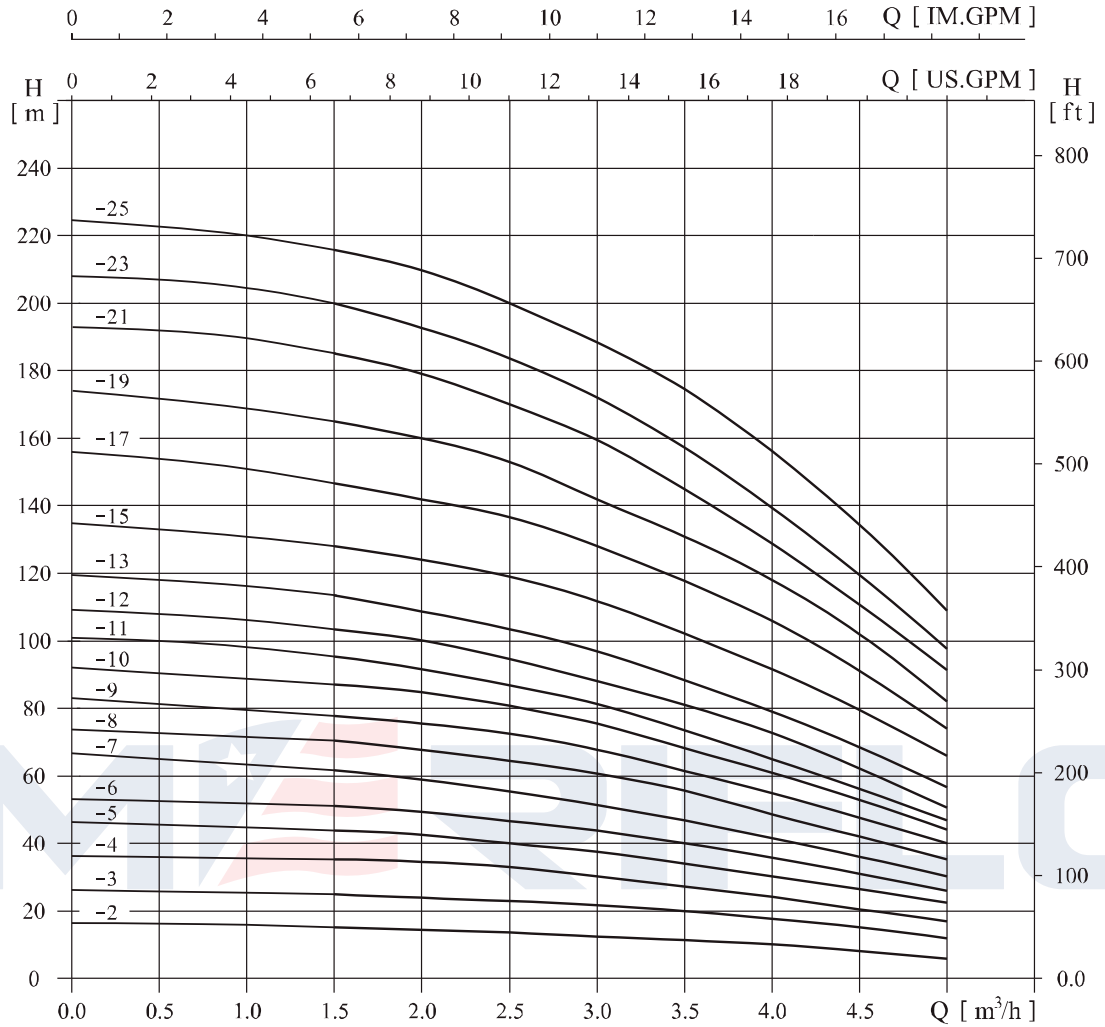
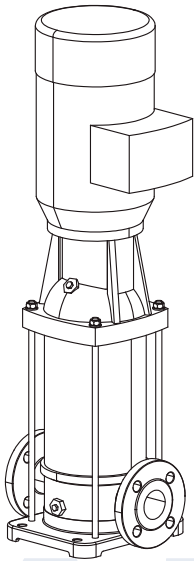

MODEL VM3 - PERFORMANCE TABLE (3500 RPM)

MODEL	SPEED	MOTOR	FLOW	7.5	10	12.5	15	17.5	20	22.5	
		HP	GPM								
VM3-2	3500	0.5	HEAD (PSI)	25	21	20	18	16	13	11	
VM3-3		0.75		130	34	33	28	26	21	17	
VM3-4		0.75		192	45	43	38	36	28	24	
VM3-5		1		62	57	54	47	44	37	33	
VM3-6		1.5		72	68	64	57	53	45	38	
VM3-7		1.5		87	80	74	65	61	54	44	
VM3-8		1.5		99	91	87	75	70	62	49	
VM3-9		2		111	102	97	85	80	71	57	
VM3-10		2		124	115	108	97	89	78	62	
VM3-11		2		136	124	116	105	98	84	68	
VM3-12		3		148	136	128	112	104	89	74	
VM3-13		3		159	148	139	122	114	98	81	
VM3-15		3		183	170	159	141	132	115	92	
VM3-17		3		209	195	182	162	151	129	105	
VM3-19		5		234	217	202	179	168	145	116	
VM3-21		5		260	241	227	200	183	159	129	
VM3-23		5		284	263	247	219	202	173	139	
VM3-25	5	308	287	266	237	219	190	153			

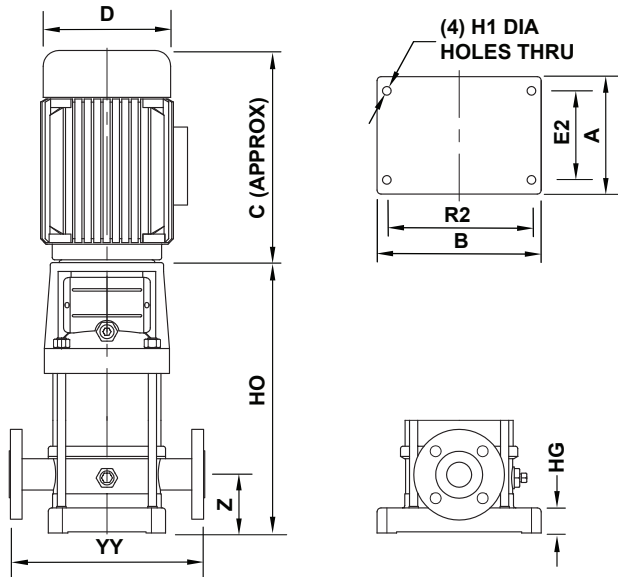
AMERIFLO**MODEL VM3 - VERTICAL MULTISTAGE, ELECTRIC NEMA MOTOR****GENERAL ARRANGEMENT DRAWING**

FLANGE DRILLING STANDARD & DETAILS						
SUCT	250# ANSI		DISC	250# ANSI		
	SIZE	RF DIA	P.C.D	# HOLES	SIZE	
SUCT	1.00	2.000	3.500	4	0.625	
DISC	1.00	2.000	3.500	4	0.625	
FORCES (LBS) & MOMENTS (LB-Feet)						
	Fx	Fy	Fz	Mx	My	Mz
SUCT	160	130	200	340	170	260
DISC	160	130	200	340	170	260

VM3

MODEL	SPEED RPM	A	B	C	D	E2	H1	HG	HO	R2	YY	Z	WEIGHT
													LBS
VM3-2	2900 3500	5.938	8.250	8.875	5.875	3.938	0.500	1.250	10.188	7.000	9.875	3.000	44
VM3-3		5.938	8.250	8.875	5.875	3.938	0.500	1.250	10.875	7.000	9.875	3.000	44
VM3-4		5.938	8.250	8.875	5.875	3.938	0.500	1.250	11.625	7.000	9.875	3.000	46
VM3-5		5.938	8.250	8.875	5.875	3.938	0.500	1.250	12.250	7.000	9.875	3.000	46
VM3-6		5.938	8.250	8.875	5.875	3.938	0.500	1.250	13.000	7.000	9.875	3.000	51
VM3-7		5.938	8.250	8.875	5.875	3.938	0.500	1.250	13.750	7.000	9.875	3.000	53
VM3-8		5.938	8.250	9.625	6.750	3.938	0.500	1.250	14.813	7.000	9.875	3.000	60
VM3-9		5.938	8.250	9.625	6.750	3.938	0.500	1.250	15.500	7.000	9.875	3.000	62
VM3-10		5.938	8.250	9.625	6.750	3.938	0.500	1.250	16.250	7.000	9.875	3.000	62
VM3-11		5.938	8.250	9.625	6.750	3.938	0.500	1.250	16.938	7.000	9.875	3.000	64
VM3-12		5.938	8.250	9.625	6.750	3.938	0.500	1.250	17.625	7.000	9.875	3.000	66
VM3-13		5.938	8.250	9.625	6.750	3.938	0.500	1.250	18.375	7.000	9.875	3.000	68
VM3-15		5.938	8.250	9.625	6.750	3.938	0.500	1.250	19.750	7.000	9.875	3.000	71
VM3-17		5.938	8.250	11.413	7.500	3.938	0.500	1.250	21.625	7.000	9.875	3.000	84
VM3-19		5.938	8.250	11.413	7.500	3.938	0.500	1.250	23.000	7.000	9.875	3.000	86
VM3-21		5.938	8.250	11.413	7.500	3.938	0.500	1.250	24.438	7.000	9.875	3.000	93
VM3-23		5.938	8.250	11.413	7.500	3.938	0.500	1.250	25.813	7.000	9.875	3.000	95
VM3-25		5.938	8.250	11.413	7.500	3.938	0.500	1.250	27.250	7.000	9.875	3.000	97
VM3-27		5.938	8.250	11.413	7.500	3.938	0.500	1.250	28.625	7.000	9.875	3.000	99
VM3-29		5.938	8.250	11.413	7.500	3.938	0.500	1.250	31.250	7.000	9.875	3.000	101
VM3-31		5.938	8.250	13.625	7.750	3.938	0.500	1.250	31.875	7.000	9.875	3.000	119
VM3-33		5.938	8.250	13.625	7.750	3.938	0.500	1.250	33.375	7.000	9.875	3.000	121
VM3-36		5.938	8.250	13.625	7.750	3.938	0.500	1.250	35.438	7.000	9.875	3.000	126

NOTES:

ALL DIMENSIONS ARE IN INCHES [MM] AND MAY VARY ±0.375 INCHES.

THIS DRAWING IS NOT TO BE USED FOR CONSTRUCTION UNLESS CERTIFIED BY AMERIFLO.

MODEL VM3 - SECTIONAL VIEW

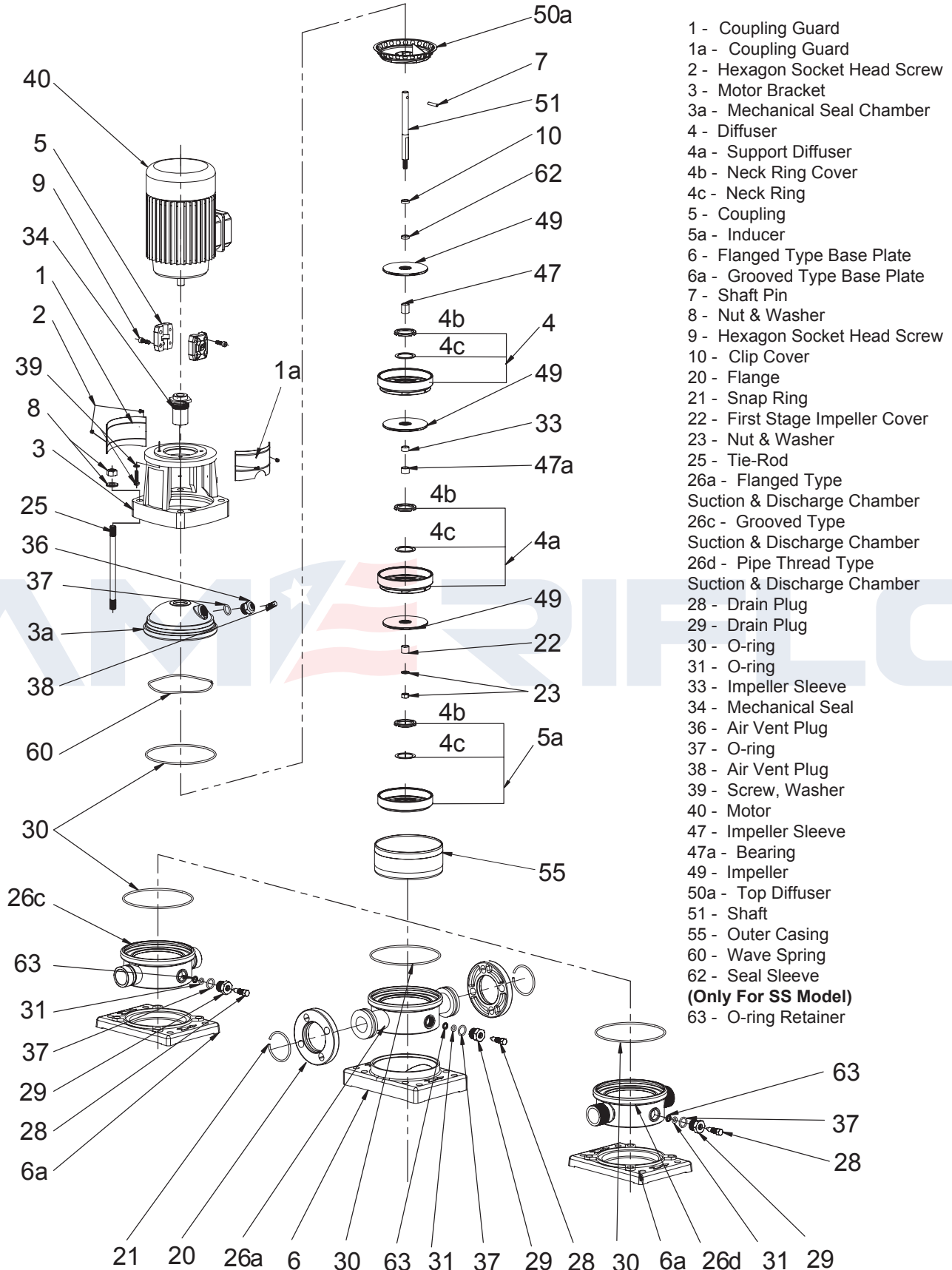

MODEL VM3 - SECTIONAL VIEW PART REFERENCE

ITEM NUMBER	PART NAME	MATERIAL	
		VM (304SS)	VM (316 SS)
1 & 1a	Coupling Guard	304 SS (EN 1.4301)	
2	Hexagon Socket Head Screw	A2-70 UNI 7323	
3	Motor Bracket	304 SS (EN 1.4301)	316 SS (EN 1.4401)
3a	Mechanical Seal Chamber		
4	Diffuser	304 SS (EN 1.4301)	316 SS (EN 1.4401)
4a	Support Diffuser	304 SS (EN 1.4301)	316 SS (EN 1.4401)
4b	Neck Ring Base Assembly	304 SS (EN 1.4301)	316 SS (EN 1.4401)
5	Coupling	Die Cast Aluminum EN AB-AISI11Cu ₂ (Fe)	
5a	Inducer	304 SS (EN 1.4301)	316 SS (EN 1.4401)
6	Flanged Type Base Plate	Die Cast Aluminum EN AB-AISI11Cu ₂ (Fe)	
6a	Grooved Type Base Plate	Die Cast Aluminum EN AB-AISI11Cu ₂ (Fe)	
7	Shaft Pin	304 SS (EN 1.4301)	316 SS (EN 1.4401)
8	Nut (M8) & Washer (M8)	A2-70 UNI 7323	
9	Hexagon Socket Head Screw	A2-70 UNI 7323	
10	Clip Cover	304 SS (EN 1.4301)	316 SS (EN 1.4401)
20	Flange	Cast Iron	
21	Snap Ring	304 SS (EN 1.4301)	
22	First Stage Impeller Cover	304 SS (EN 1.4301)	316 SS (EN 1.4401)
23	Nut (M8) & Washer (M8)	A2-70 UNI 7323	
25	Tie-Rod	Galvanized Steel 6.8 Strength Class ISO 898/1	
26a	Flanged Type Suction & Discharge Chamber	304 SS (EN 1.4301)	316 SS (EN 1.4401)
26c	Grooved Type Suction & Discharge Chamber	304 SS (EN 1.4301)	316 SS (EN 1.4401)
26d	Pipie Thread Type Suction & Discharge Chamber	304 SS (EN 1.4301)	316 SS (EN 1.4401)
28	Drain Plug (M10)	304 SS (EN 1.4301)	316 SS (EN 1.4401)
29	Drain Plug	304 SS (EN 1.4301)	316 SS (EN 1.4401)
30	O-Ring	FPM	
31	O-Ring	FPM	
33	Impeller Sleeve	Tungsten Carbide	
34	Mechanical Seal	Silicon Carbide / Carbon / FPM	
36	Air Vent Plug	304 SS (EN 1.4301)	316 SS (EN 1.4401)
37	O-Ring	FPM	
38	Air Vent Plug	304 SS (EN 1.4301)	316 SS (EN 1.4401)
39	Screw & Washer	Galvanized Steel	
40	Motor	Refer To Motor Manufacturer	
47	Impeller Sleeve	Tungsten Carbide	
47a	Bearing	Tungsten Carbide	
49	Impeller	304 SS (EN 1.4301)	316 SS (EN 1.4401)
50a	Top Diffuser	304 SS (EN 1.4301)	316 SS (EN 1.4401)
51	Shaft	304 SS (EN 1.4301)	316 SS (EN 1.4401)
55	Outer Casing	304 SS (EN 1.4301)	316 SS (EN 1.4401)
60	Wave Spring	A2-70 UNI 7323	
62	Seal Sleeve	Tungsten Carbide	
63	O-ring Retainer	304 SS (EN 1.4301)	316 SS (EN 1.4401)

MODEL VM3 - ENGINEERING INFORMATION

PUMP MODEL	OPERATING TEMPERATURE RANGE	MECHANICAL SEAL TYPE	MECHANICAL SEAL MATERIAL				
			ROTATING FACE	STATIONARY FACE	ELASTOMERS	SPRING	COLLAR
VM3	+5°F TO +248°F [-15°C TO +120°C]	BALANCED	SILICON CARBIDE	CARBON	FPM	316 SS	316 SS

RATED FLOW:	13.2 GPM [3 M ³ /HR]
FLOW RANGE:	6.6 - 22 GPM [1.5 - 5 M ³ /HR]
MAXIMUM PRESSURE:	334 PSI [23 BAR]
MAXIMUM POWER:	0.50 - 5 HP [0.37 - 4 KW]
MAXIMUM EFFICIENCY:	54%

